

Barry Township
T 1 N R 9 W
Barry County
Michigan

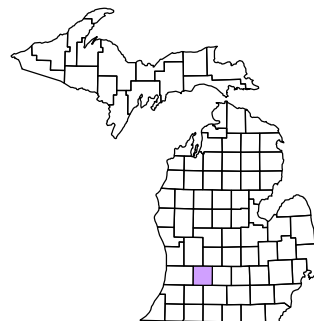

1	2	3	4	5	6	7	8	9	10	11	12
13	14	15	16	17	18	19	20	21	22	23	24
25	26	27	28	29	30	31	32	33	34	35	36

NE 1/4 SE 1/4
Section 6
08-03-006-
Scale 1" = 100'

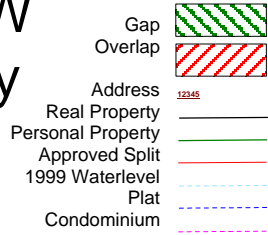
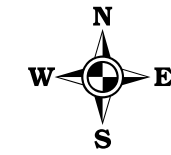

November 2008

This tax map was compiled for tax administration purposes from county and township records. It does not represent a land survey. Barry County Land Information Services 220 West State Street, Hastings MI 49058 (269) 945-1292 or <http://www.barrycounty.org/>

All dimensions are from tax roll unless noted below.
D = deeded M or S = surveyed
SR = Surveyor's Record prior to 1915
GLO = Government Land Office circa. 1830

08-03-070-079-00 overlaps 080 and has wrong plat name.
08-03-070-080-00 has the wrong plat name.

08-03-070-041-00 is describing the wrong property and should be over in the Blackman & Bush's Addition.

08-03-070-051-00 has the wrong plat name.

08-03-070-052-00 has the wrong plat name.

08-03-070-054-00 has the wrong plat name.

08-03-070-056-00 has the wrong plat name.

08-03-070-022-00 is missing the point of beginning in the first description.

08-03-070-072-01 has the wrong plat name.

08-03-070-072-02 has the wrong plat name.

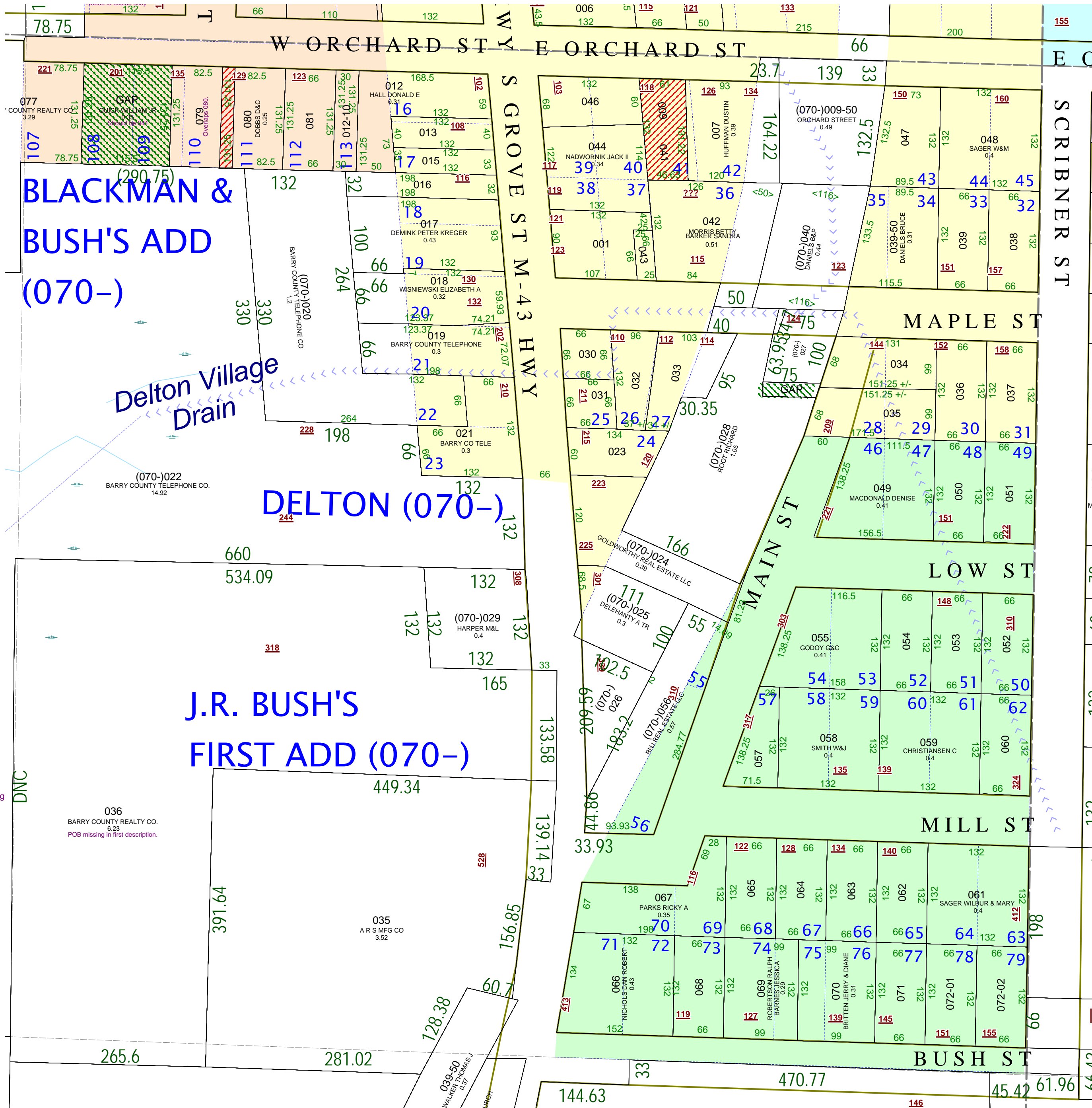

BLACKMAN & BUSH'S ADD (070-)

DELTON (070-)

J.R. BUSH'S FIRST ADD (070-)

Delton Village Drain