

Barry Township  
T 1 N R 9 W  
Barry County  
Michigan

Legend:

- Gap: Green diagonal lines
- Overlap: Red diagonal lines
- Address: Solid line
- Real Property: Dashed line
- Personal Property: Dotted line
- Approved Split: Solid line with dots
- 1999 Waterlevel: Solid line with dashes
- Plat: Solid line with squares
- Condominium: Dashed line with squares

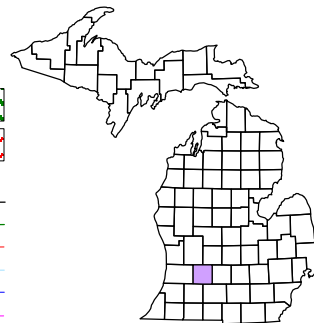

6	5	4	3	2	1
7	8	9	10	11	12
13	14	15	16	17	18
19	20	21	22	23	24
25	26	27	28	29	30
31	32	33	34	35	36

SW 1/4 NW 1/4  
Section 7  
08-03-007-  
Scale 1"= 100'

This tax map was compiled for tax administration purposes from county and township records. It does not represent a land survey. Barry County Land Information Services 220 West State Street, Hastings MI 49058 (269) 945-1292 or <http://www.barrycounty.org/>

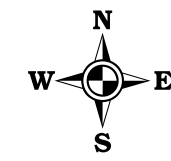

November 2008

All dimensions are from tax roll unless noted below.  
D = deeded M or S = surveyed  
SR = Surveyor's Record prior to 1915  
GLO = Government Land Office circa. 1830

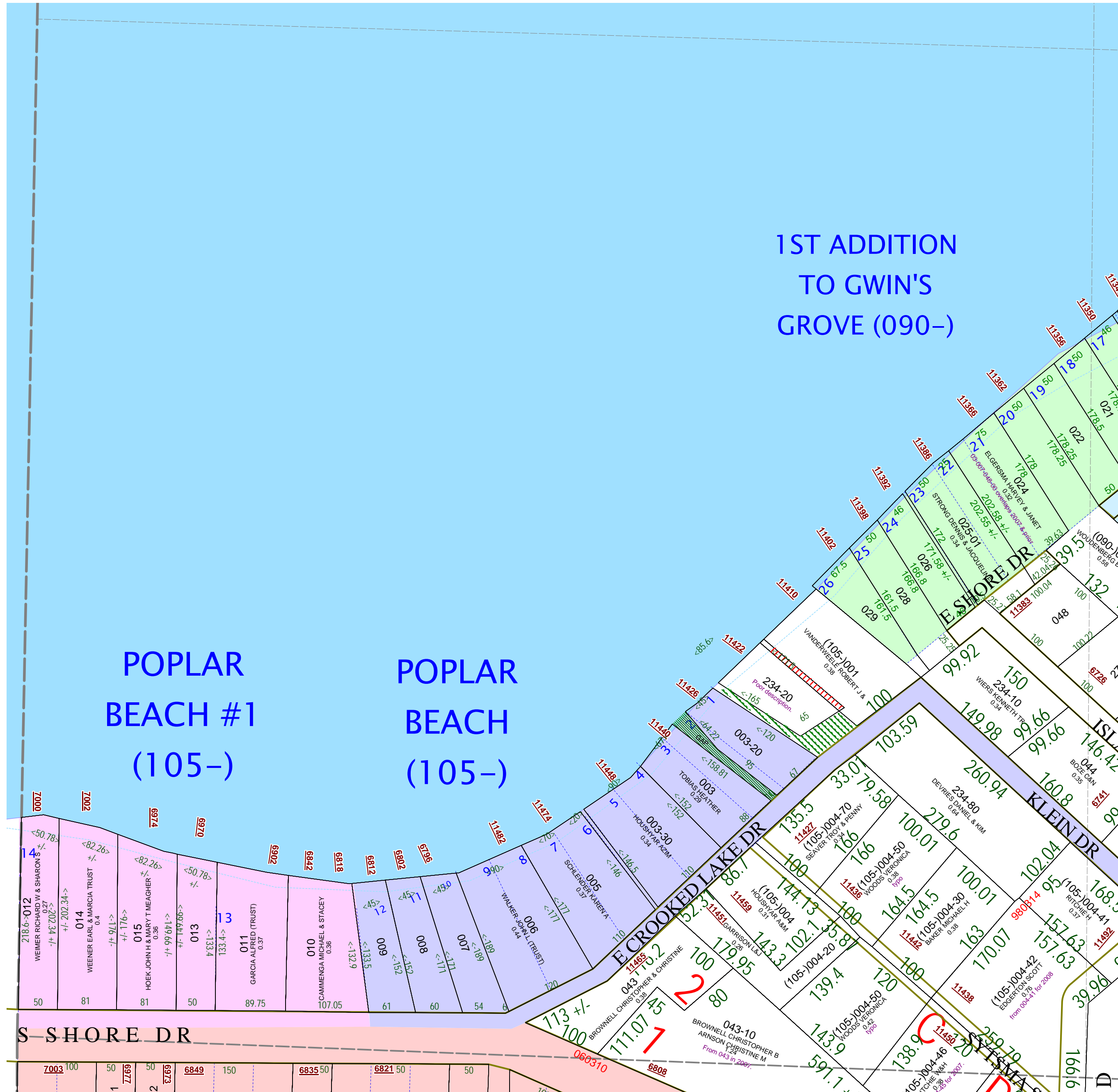

08-03-105-007-00 has the plat name misspelled, it should be "POPLAR" not Popular.  
08-03-105-008-00 has the plat name misspelled, it should be "POPLAR" not Popular.

GAP in lot 24 of 1st Addition to Gwin's Grove which is used for backlot access owned by Mason L. & Fern Norwood in L.256-341.

08-03-007-234-20 has a poor point of beginning, I think they assumed the south corner of Gwin's Grove was on the southerly point of the old road way rather than on the south corner of the lot.

GAP in lot 2 of Poplar Beach for backlot access owned by James P. & Florence J Syssema in L.374-726.

08-03-105-004-50 has a small typo, change "TH 49D 1M 29S E 79.58 FT" to "TH S49°01'29"E 79.58FT".