

Barry Township
T 1 N R 9 W
Barry County
Michigan

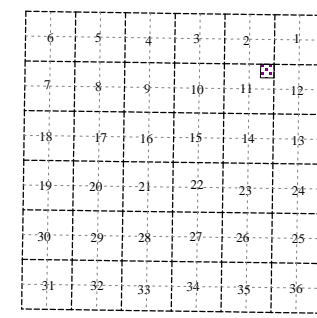

NE 1/4 NE 1/4
Section 11
08-03-011-
Scale 1"= 100'

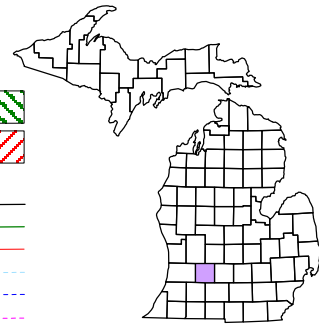
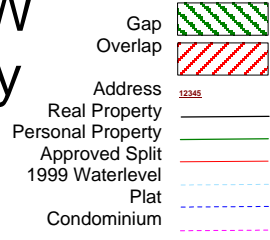

November 2008

This tax map was compiled for tax administration purposes from county and township records. It does not represent a land survey. Barry County Land Information Services 220 West State Street, Hastings MI 49058 (269) 945-1292 or <http://www.barrycounty.org/>

All dimensions are from tax roll unless noted below. D = deeded M or S = surveyed SR = Surveyor's Record prior to 1915 GLO = Government Land Office circa. 1830

005-03
CARPENTER JOHN & BABARA
70.7

FAIR LAKE

(242 acres)

CEDAR POINTS (055-)

SUPERVISOR'S REPLAT OF PARTS OF LOTS 28-34 OF CEDAR POINT PLAT (055-)

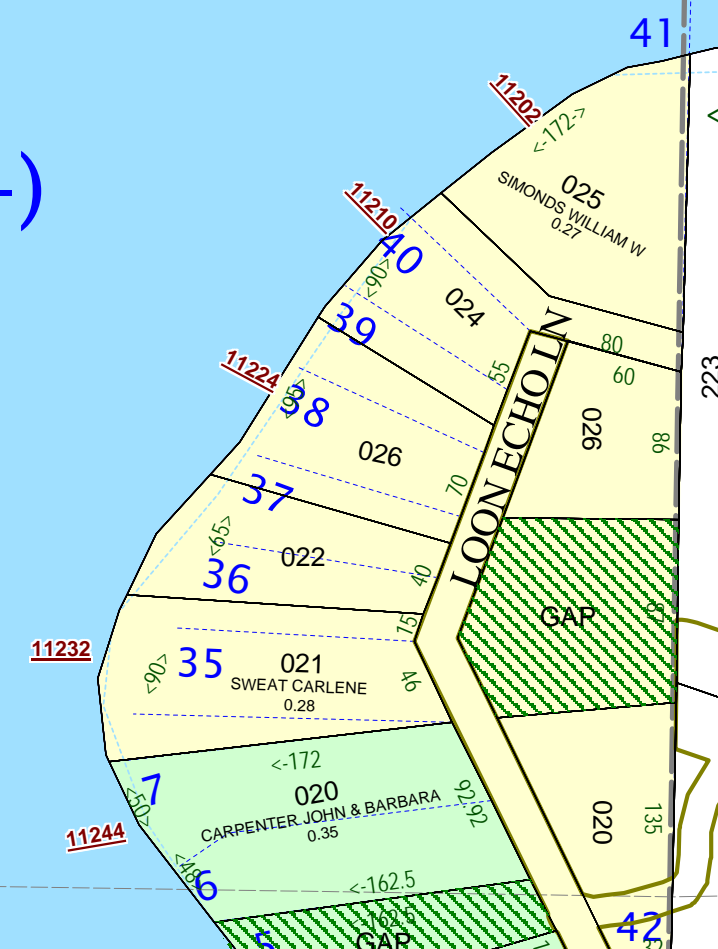

GAP in Lot 42 Cedar Point Plat, owned by Sweat from 021 & 022. The property line goes through the house on the lake side and the back lot is not assessed.

08-03-055-020-00 needs to include gap parcel to its south.