

City of Hastings
 T 3 N R 8 W
 Barry County
 Michigan
 Sheet 6

Legend:

- Gap: [Green hatched box]
- Overlap: [Red hatched box]
- Address: 1234
- Real Property: [Solid black line]
- Personal Property: [Dashed black line]
- Plat: [Dotted black line]
- Condominium: [Dashed red line]

SW 1/4 Section 7
 08-55-100-
 Scale 1"= 200'



June 1998
 Revised July 2000
 Revised December 2002
 Revised May 2004
 Revised September 2005
 Revised January 2007
 Revised August 2008

All dimensions are from tax roll unless noted below.
 D = deeded M or S = surveyed
 SR = Surveyor's Record prior to 1915
 GLO = Government Land Office circa. 1830

This tax map was compiled for tax administration purposes from county and township records. It does not represent a land survey.
 Barry County Land Information Services
 220 West State Street, Hastings MI 49058
 (269) 945-1292 or <http://www.barrycounty.org/>

City of Hastings - Sheet 2

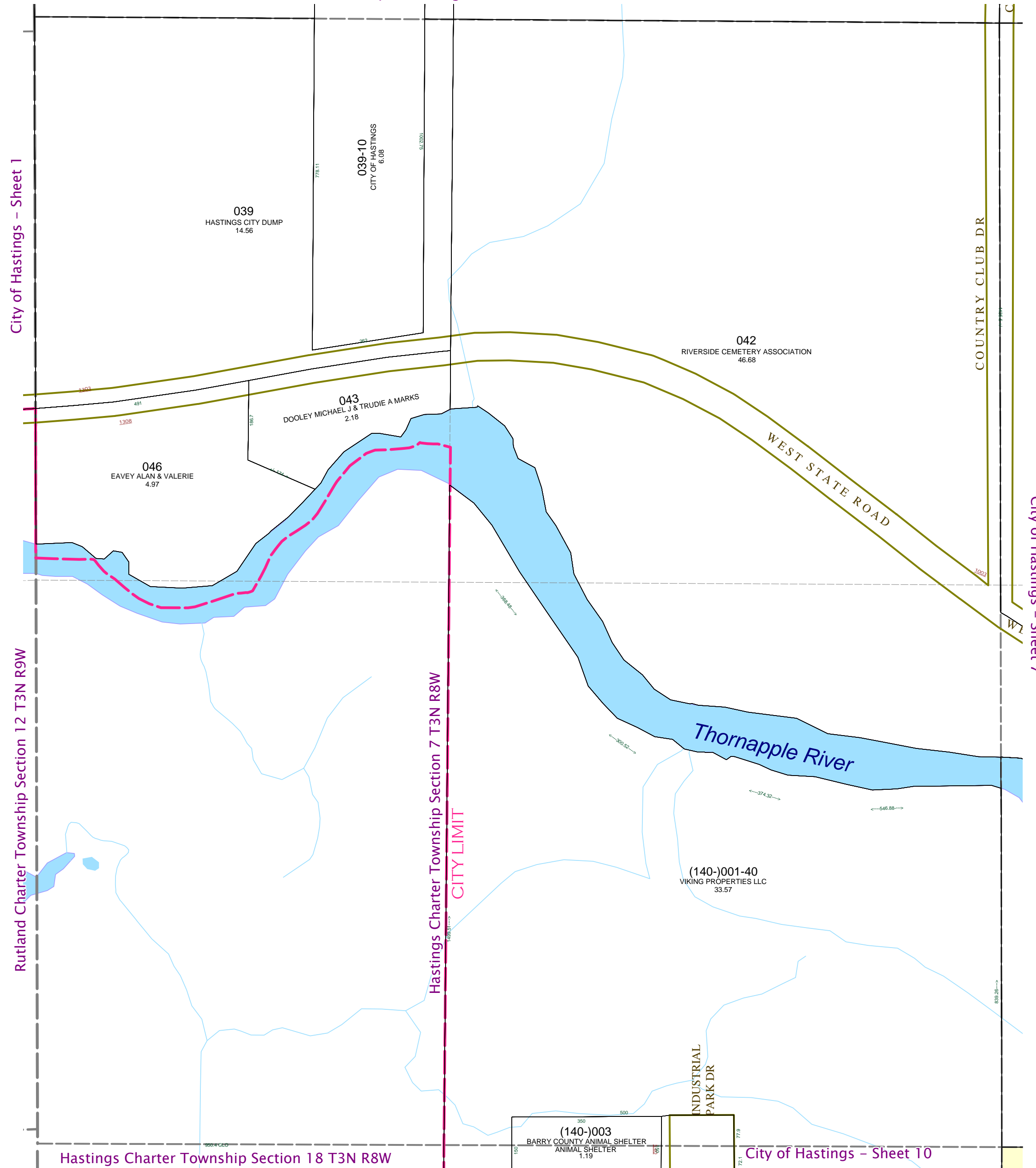

City of Hastings - Sheet 1

Rutland Charter Township Section 12 T3N R9W

Hastings Charter Township Section 18 T3N R8W

Hastings Charter Township Section 7 T3N R8W

CITY LIMIT

City of Hastings - Sheet 7

City of Hastings - Sheet 10

(140)-003
 BARRY COUNTY ANIMAL SHELTER
 ANIMAL SHELTER
 1.19

INDUSTRIAL PARK DR