

City of Hastings
T 3 N R 8 W
Barry County
Michigan
Sheet 22

- Gap
- Overlap
- Address 1234
- Real Property
- Personal Property
- Plat
- Condominium

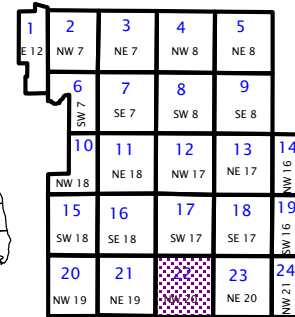

NW 1/4 Section 20
08-55-260-
Scale 1" = 200'

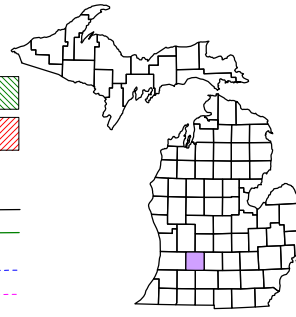
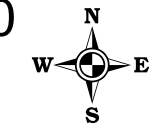

June 1998
Revised July 2000
Revised December 2002
Revised May 2004
Revised September 2005
Revised January 2007
Revised September 2008

All dimensions are from tax roll unless noted below.
D = deeded M or S = surveyed
SR = Surveyor's Record prior to 1915
GLO = Government Land Office circa. 1830

This tax map was compiled for tax administration purposes from county and township records. It does not represent a land survey.
Barry County Land Information Services
220 West State Street, Hastings MI 49058
(269) 945-1292 or http://www.barrycounty.org/

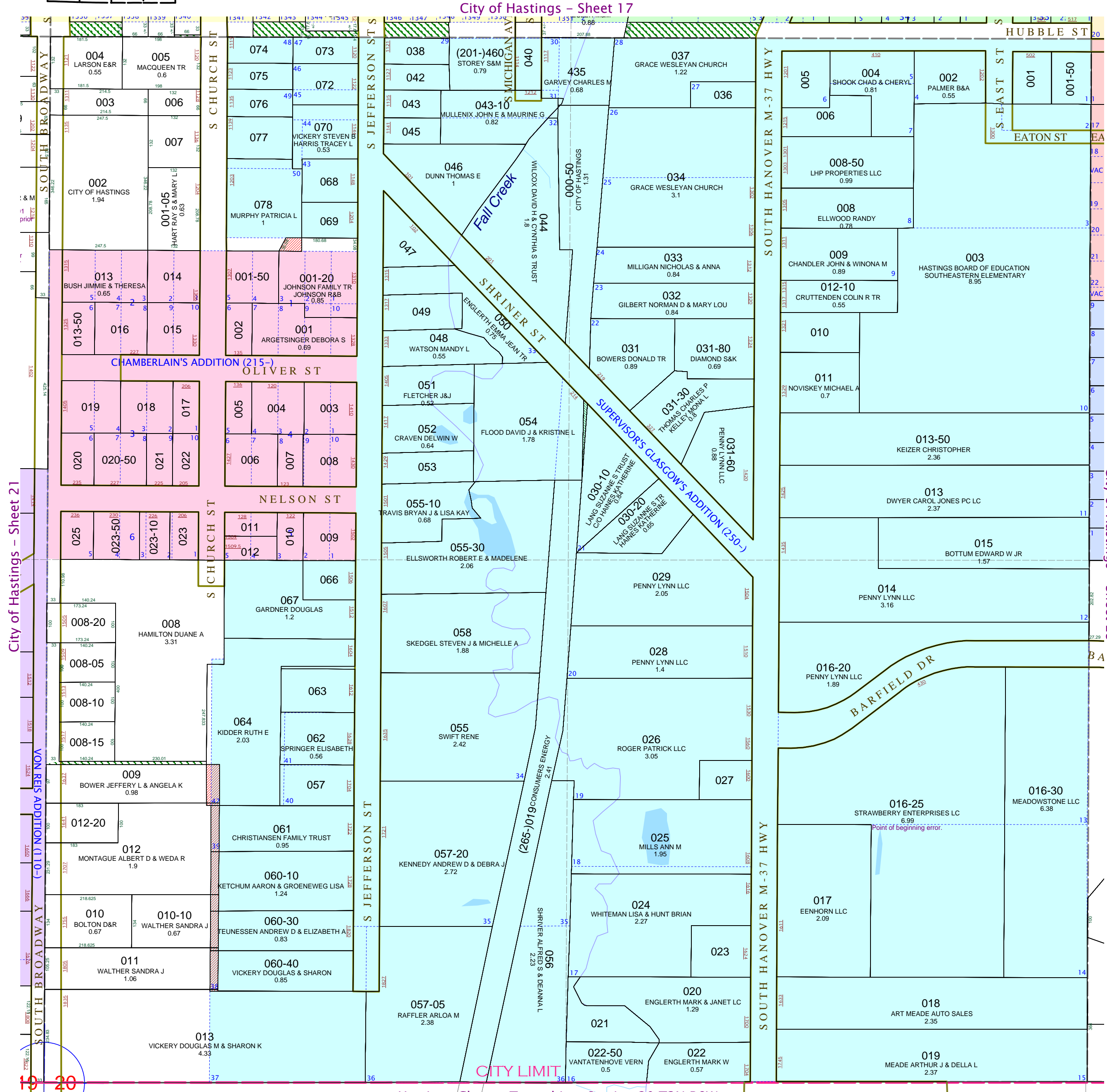

City of Hastings - Sheet 21

City of Hastings - Sheet 23

19 20

Hastings Charter Township - Section 20 T3N R8W

08-55-250-016-25 is missing point of beginning. See R#1039592.