

YANKEE SPRINGS	RUTLAND	HASTINGS	CASTLETON
ORANGEVILLE	HOPE	BALTIMORE	MAPLE GROVE
PRAIRIEVILLE	DIXON BARRY	JEHNSTOWN	ASSYRIA

City of Hastings
T 3 N R 8 W
Barry County
Michigan
Sheet 24

- Gap
- Overlap
- Address 1234
- Real Property
- Personal Property
- Plat
- Condominium

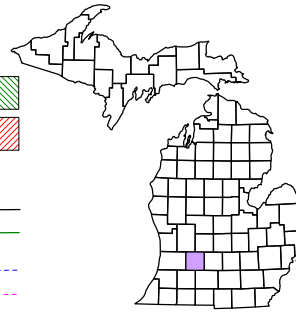

1	2	3	4	5
6	7	8	9	
10	11	12	13	14
15	16	17	18	19
20	21	22	23	24

NW 1/4 Section 21
08-55-265-
Scale 1"= 200'



June 1998
Revised July 2000
Revised December 2002
Revised May 2004
Revised September 2005
Revised January 2007
Revised September 2008

All dimensions are from tax roll unless noted below.
D = deeded M or S = surveyed
SR = Surveyor's Record prior to 1915
GLO = Government Land Office circa. 1830

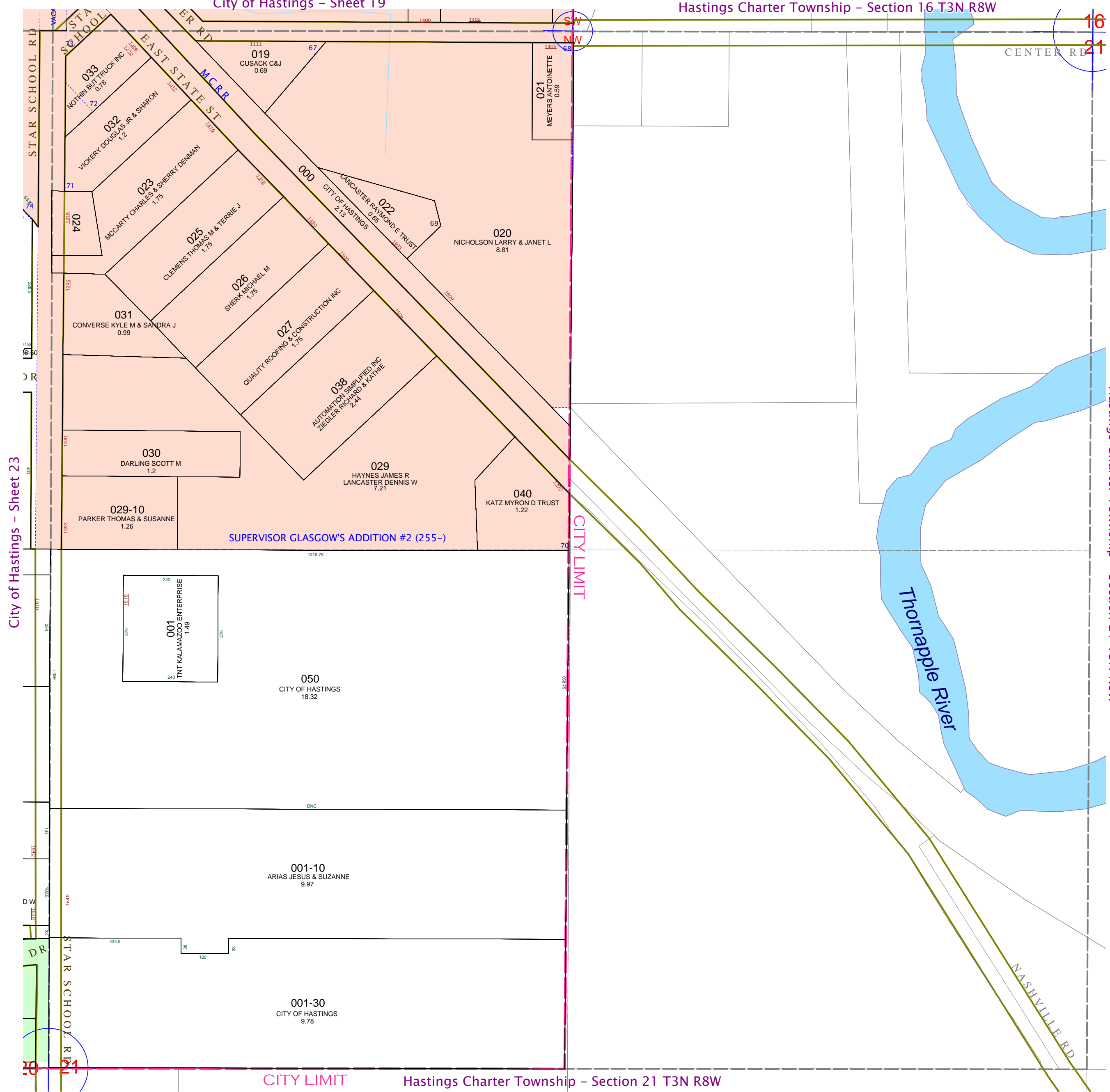

City of Hastings - Sheet 23

City of Hastings - Sheet 19

Hastings Charter Township - Section 16 T3N R8W

Hastings Charter Township - Section 21 T3N R8W

CITY LIMIT Hastings Charter Township - Section 21 T3N R8W