

Hastings Charter
Township
T 3 N R 8 W
Barry County
Michigan

- Gap
- Overlap
- Address
- Real Property
- Personal Property
- Approved Split
- Plat
- Condominium
- Mobile Home Park

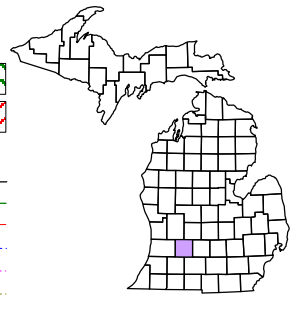

6	5	4	3	2	1
7	8	9	10	11	12
13	14	15	16	17	18
19	20	21	22	23	24
25	26	27	28	29	30
31	32	33	34	35	36

NE 1/4 Section 25
08-06-025-
Scale 1" = 200'

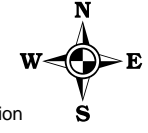

February 2001
Revised September 2004
Revised July 2006
Revised December 2008

This tax map was compiled for tax administration purposes from county and township records. It does not represent a land survey. Barry County Land Information Services 220 West State Street, Hastings MI 49058 (269) 945-1292 or <http://www.barrycounty.org/>

All dimensions are from tax roll unless noted below.
D = deeded M or S = surveyed
SR = Surveyor's Record prior to 1915
GLO = Government Land Office circa. 1830

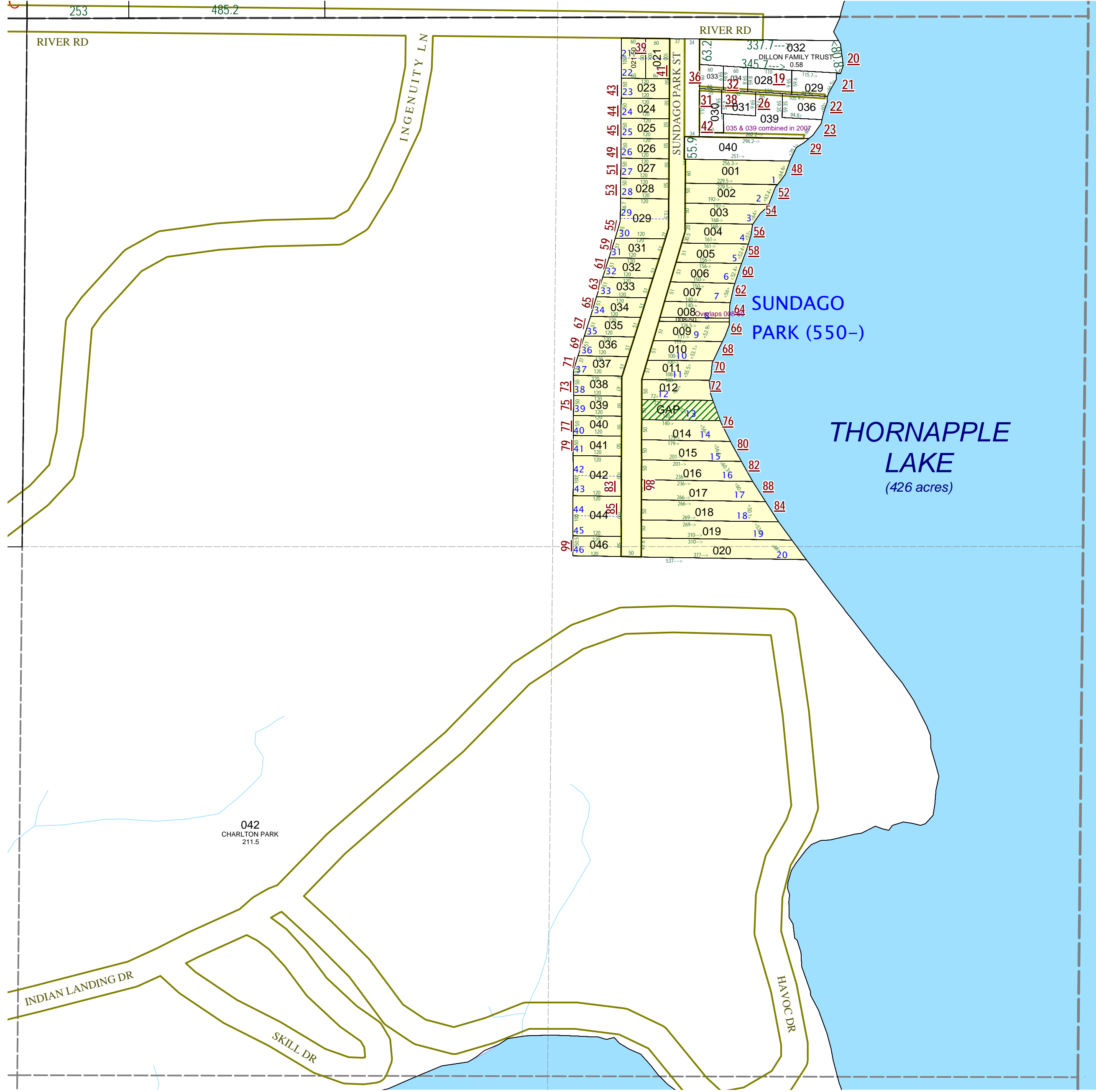

08-06-550-008-00 overlaps 008-50 because a 51 foot wide lot minus 10 feet cannot be 42 feet wide. Correction reads from L.594-26.

owned by Howard P. Kelly and serves as the access lot for all the back lots in Sundago Park.