

Rutland Charter Township  
T 3 N R 9 W  
Barry County  
Michigan

- Address 1234
- Gap
- Overlap
- Real Property
- Personal Property
- Approved Split
- Plat
- Condominium
- Mobile Home Park

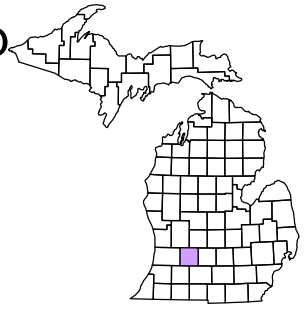

6	5	4	3	2	1
7	8	9	10	11	
18	17	16	15	14	13
19	20	21	22	23	24
30	29	28	27	26	25
31	32	33	34	35	36

Section 12  
08-13-012-  
Scale 1" = 400'

This tax map was compiled for tax administration purposes from county and township records. It does not represent a land survey. Barry County Land Information Services 220 West State Street, Hastings MI 49058 (269) 945-1292 or <http://www.barrycounty.org/>

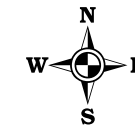

February 1997  
Revised October 1998  
Revised August 2000  
Revised October 2002  
Revised February 2004  
Revised January 2005  
Revised May 2006  
Revised November 2007

All dimensions are from tax roll unless noted below.  
D = deeded M or S = surveyed  
SR = Surveyor's Record prior to 1915  
GLO = Government Land Office circa. 1830

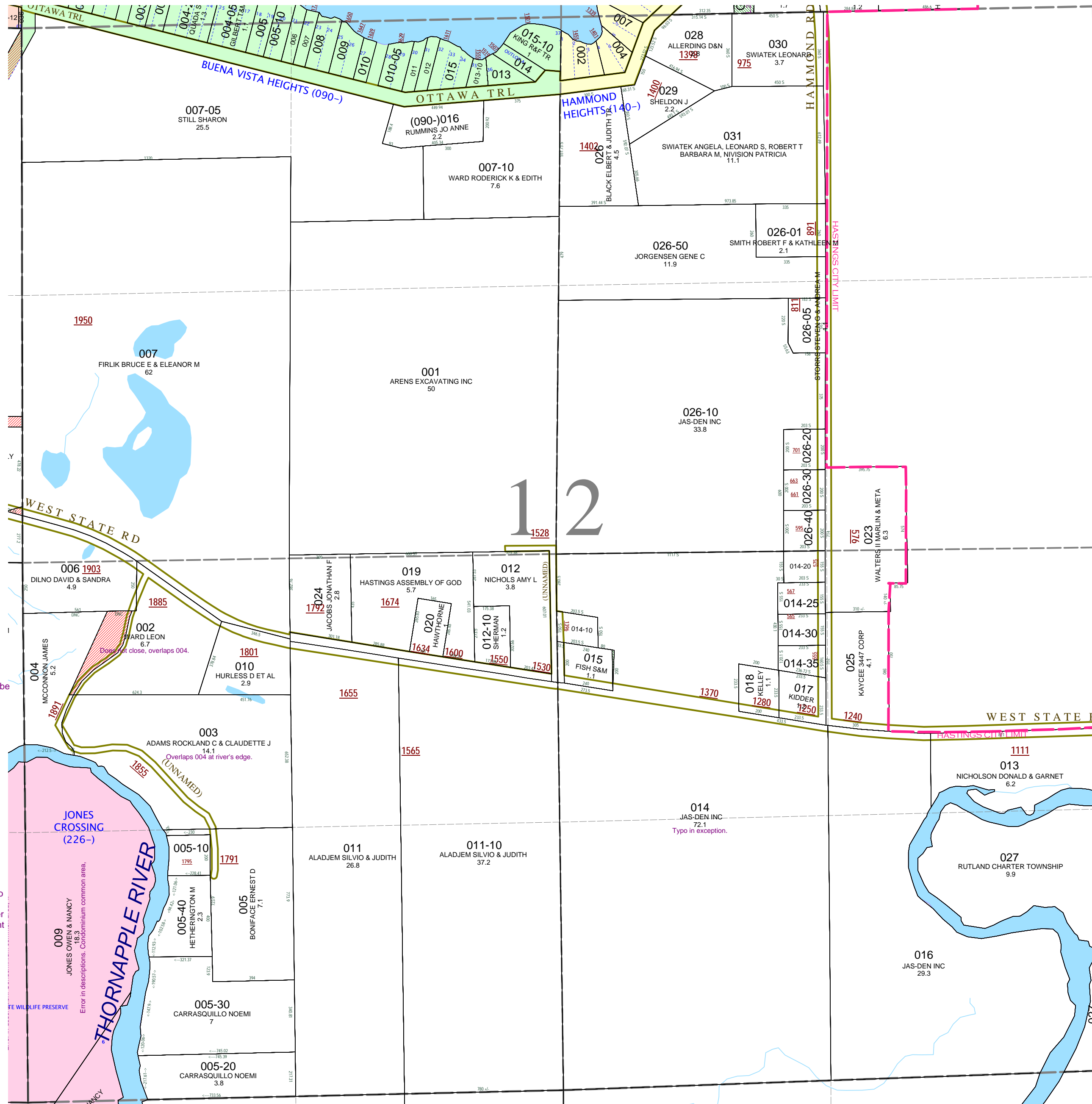

08-13-012-002-00 does not close and overlaps 004-00. See R#1004720.  
08-13-012-003-00 overlaps 004-00 and should be described as deeded in R#1085337.

08-13-012-009-00 would technically describe no property. There is no un-platted land between Jones Crossing and the River. There is however a private wildlife preserve as a common element to the plat which would be owned jointly by all plat owners.

08-13-012-014-00 has a small typo its exception of 015-00.