

Rutland Charter Township T 3 N R 9 W Barry County Michigan

Address 1234
 Gap
 Overlap
 Real Property
 Personal Property
 Approved Split
 Plat
 Condominium
 Mobile Home Park

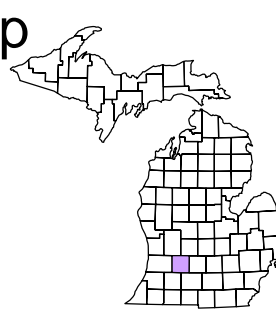

Section 4 08-13-004- Scale 1" = 400'

This tax map was compiled for tax administration purposes from county and township records. It does not represent a land survey. Barry County Land Information Services 220 West State Street, Hastings MI 49058 (269) 945-1292 or <http://www.barrycounty.org/>



February 1997
 Revised October 1998
 Revised August 2000
 Revised October 2002
 Revised February 2004
 Revised January 2005
 Revised May 2006
 Revised November 2007
 Revised June 2009
 All dimensions are from tax roll unless noted below.
 D = deeded M or S = surveyed
 SR = Surveyor's Record prior to 1915
 GLO = Government Land Office circa. 1830

08-13-004-012-00 overlaps 012-10 with a tiny little triangle in the northwest corner of 012-10 which is excluded as the third exception to L.385-146.

08-13-004-017-00 does not have width parcel after sale to Munjoy.

GAP owned by Leo & Ilene Seeber in L.293-144 and not placed in the Ilene Seeber Trust in R#1026666.

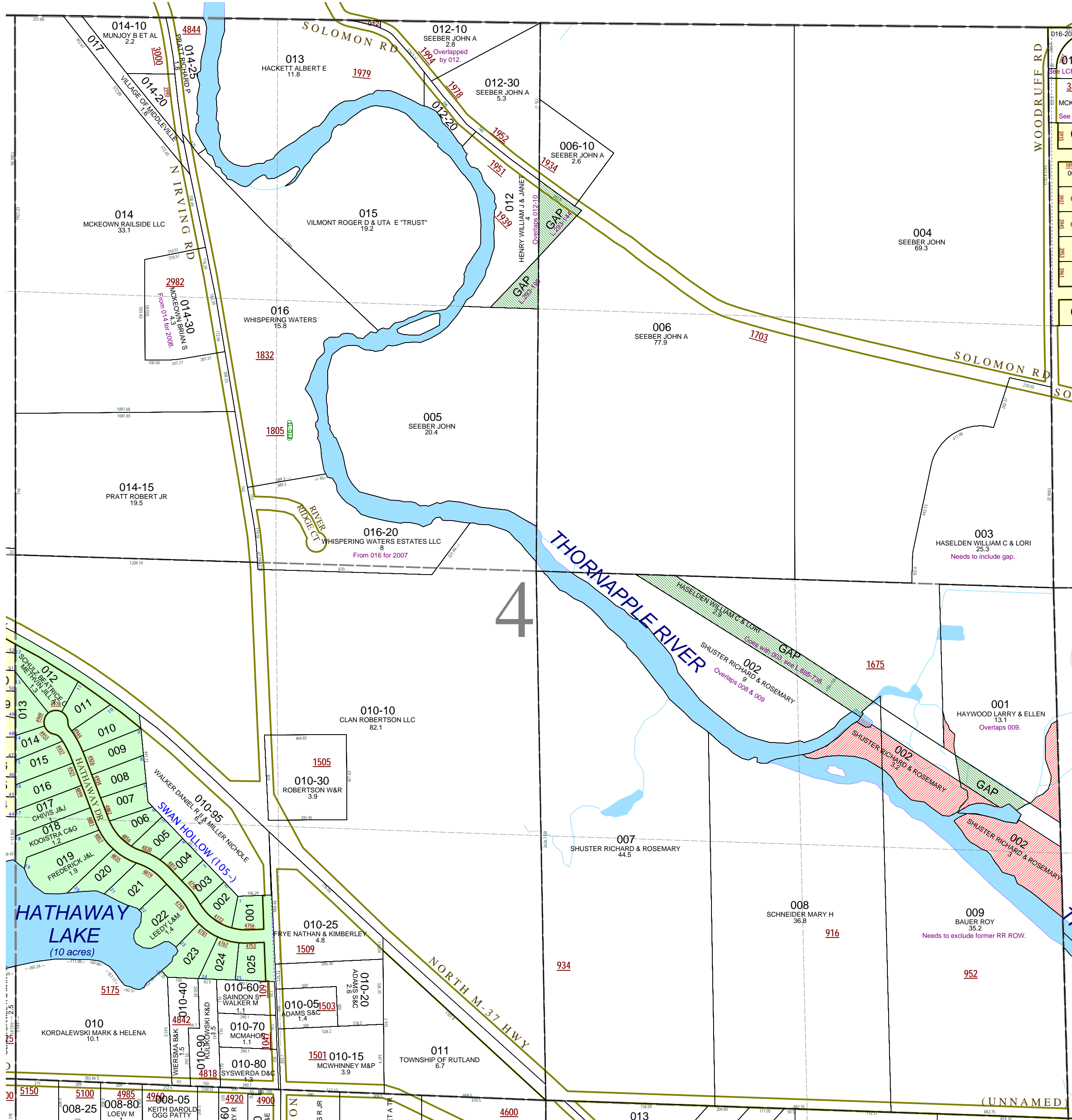

GAP owned by Hecker in L.293-195 and not sold onto Pantera in L.353-486.

08-13-004-003-00 should include adjacent gap parcel deeded in L.685-738

08-13-004-001-00 overlaps 009 and should exclude parcels lying south of the old course of the river not the dredged course.

08-13-004-002-00 overlaps 008 & 009 and should exclude parcels lying south of the old course of the river not the dredged course.

08-13-004-009-00 needs to exclude railroad parcel which is owned by Haselden on 003.