

Rutland Charter Township
T 3 N R 9 W
Barry County
Michigan

- Address 1234
- Gap
- Overlap
- Real Property
- Personal Property
- Approved Split
- Plat
- Condominium
- Mobile Home Park

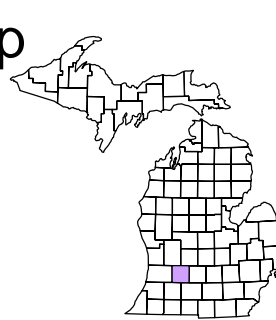

Section 14
08-13-014-
Scale 1" = 400'

This tax map was compiled for tax administration purposes from county and township records. It does not represent a land survey. Barry County Land Information Services 220 West State Street, Hastings MI 49058 (269) 945-1292 or <http://www.barrycounty.org/>

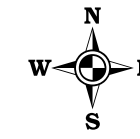

February 1997
Revised October 1998
Revised August 2000
Revised October 2002
Revised February 2004
Revised January 2005
Revised May 2006
Revised November 2007
Revised June 2009
All dimensions are from tax roll unless noted below.
D = deeded M or S = surveyed
SR = Surveyor's Record prior to 1915
GLO = Government Land Office circa. 1830

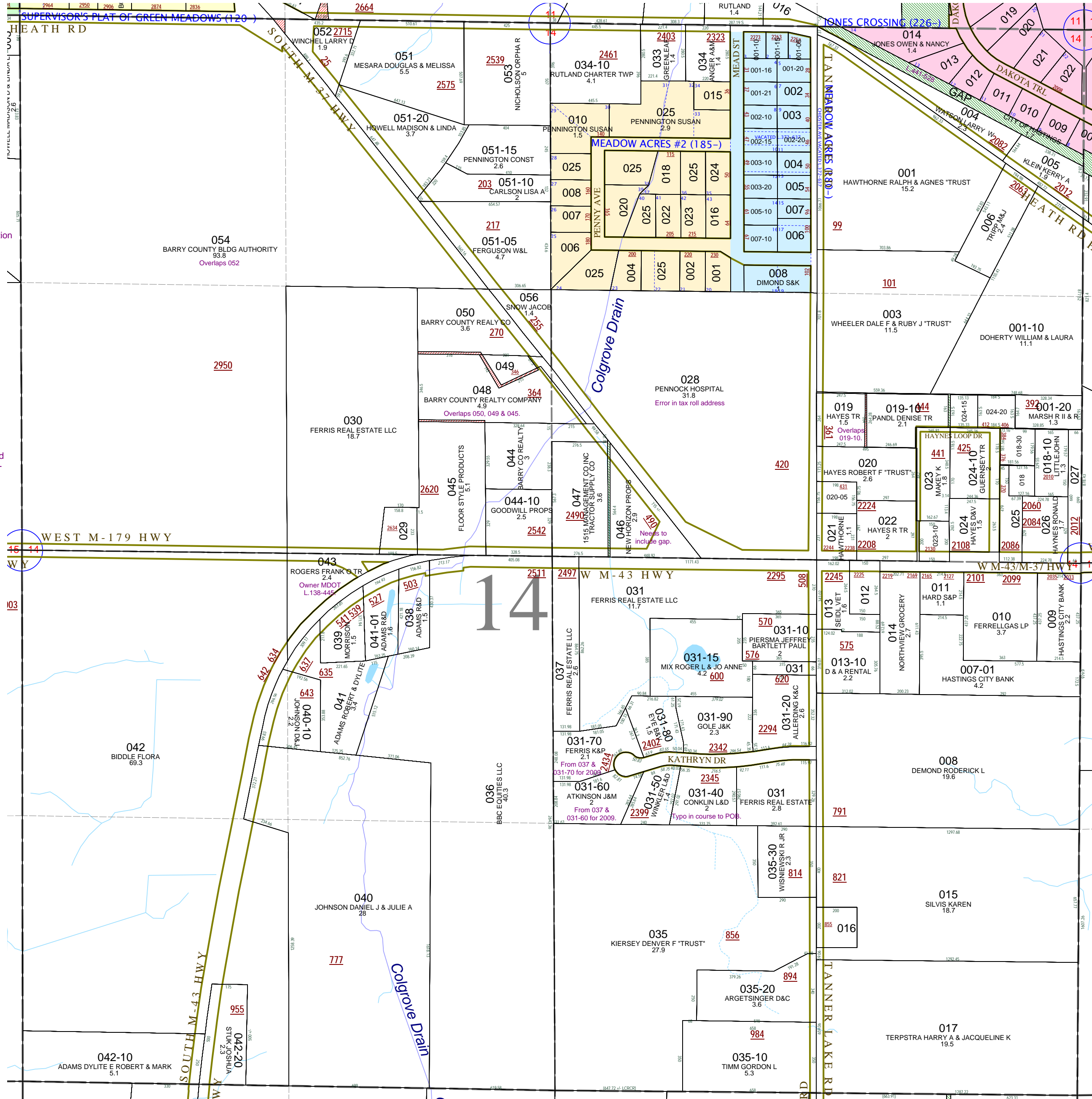

08-13-014-054-00 overlaps 052-00 by the duplication of section, town and range information before the exception is made.

08-13-014-048-00 overlaps 050, 049 & 045 and should be described as deeded in #20070917-0002044.

08-13-014-043-00 just a note that the owner of record is MDOT in L.138-445.

GAPs owned by City of Hastings in L.441-528.

08-13-014-019-10 overlaps 019-00 due to a section line which is short 9.34 feet more or less.

08-13-014-046-00 needs to include 20 feet wide gap to its west. See R#1068269.

08-13-014-031-40 has a typo, the measure of 392.81 feet should be 392.61 feet.