

Rutland Charter Township
T 3 N R 9 W
Barry County
Michigan

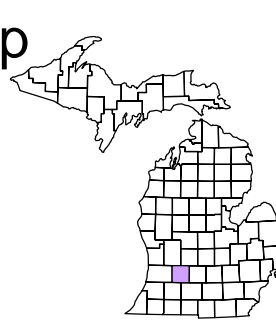

NE 1/4 Section 14
08-13-014-
Scale 1" = 200'

This tax map was compiled for tax administration purposes from county and township records. It does not represent a land survey. Barry County Land Information Services 220 West State Street, Hastings MI 49058 (269) 945-1292 or <http://www.barrycounty.org/>

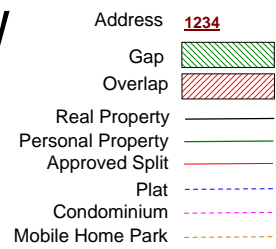
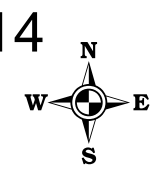

August 2000
Revised October 2002
Revised February 2004
Revised January 2005
Revised May 2006
Revised November 2007
Revised June 2009

All dimensions are from tax roll unless noted below.
D = deeded M or S = surveyed
SR = Surveyor's Record prior to 1915
GLO = Government Land Office circa. 1830

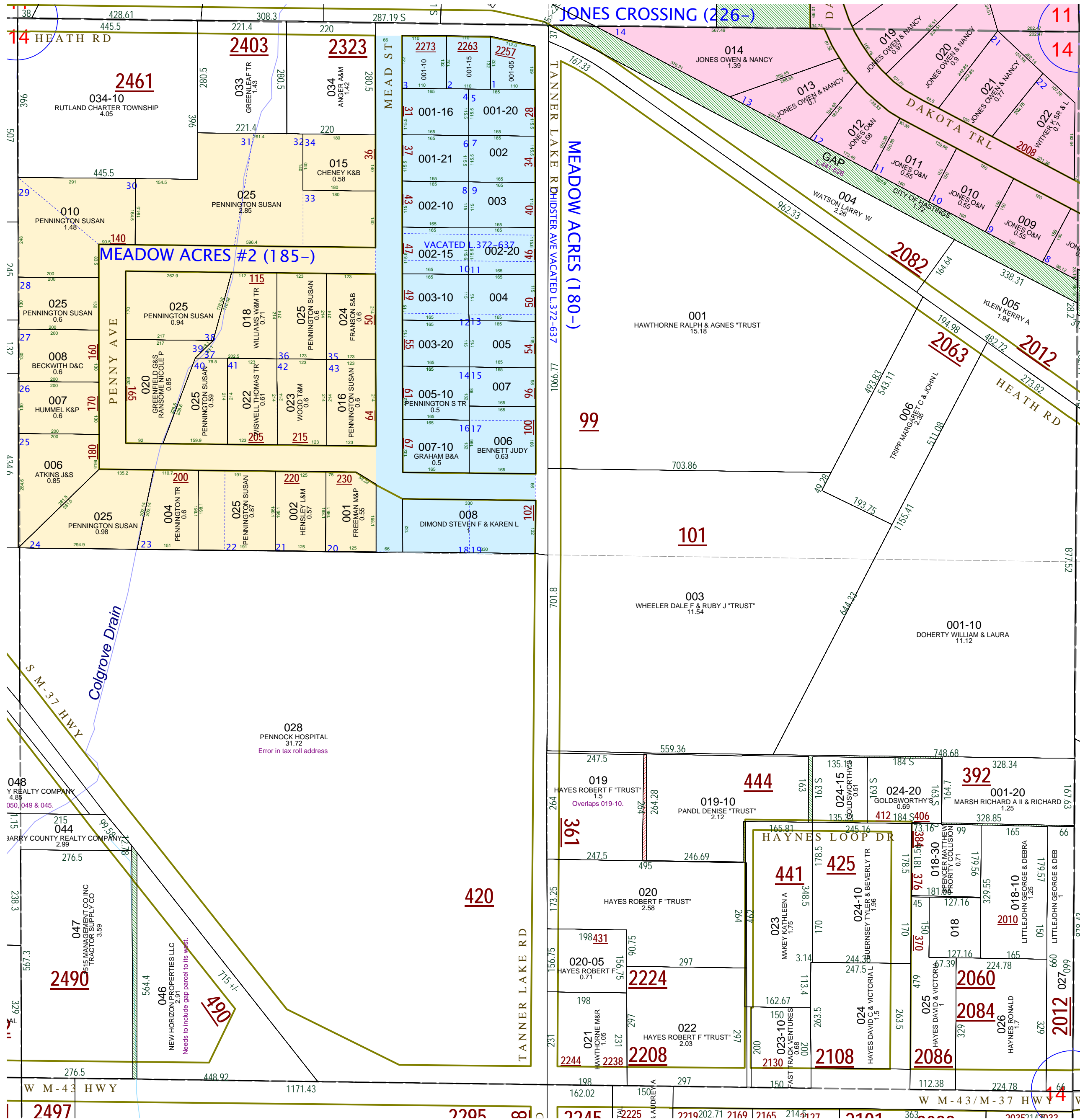

GAPs owned by City of Hastings in L.441-528.

08-13-014-048-00 overlaps 050, 049 & 045 and should be described as deeded in #20070917-0002044.

08-13-014-019-10 overlaps 019-00 due to a section line which is short 9.34 feet more or less.

08-13-014-046-00 needs to include 20 feet wide gap to its west. See R#1068269.