

Irving Township
T 4 N R 9 W
Barry County
Michigan

- Gap
- Overlap
- Address
- Real Property
- Personal Property
- Approved Split
- Plat
- Condominium
- Mobile Home Park

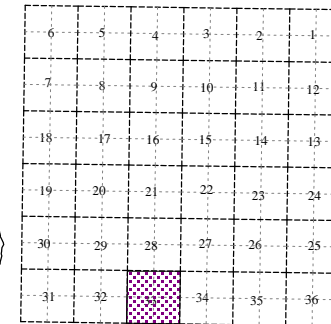

Section 33
08-08-033-
Scale 1" = 400'

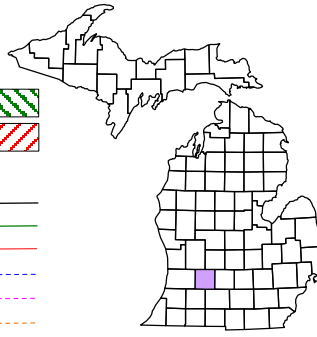

January 1998
Revised May 2000
Revised January 2002
Revised July 2003
Revised November 2004
Revised June 2006
Revised October 2008

All dimensions are from tax roll unless noted below.
D = deeded M or S = surveyed
SR = Surveyor's Record prior to 1915
GLO = Government Land Office circa. 1830

This tax map was compiled for tax administration purposes from county and township records. It does not represent a land survey.
Barry County Land Information Services
220 West State Street, Hastings MI 49058
(269) 945-1292 or <http://www.barrycounty.org/>

GAP owned by Gary & Barbara Thorne and not deeded to James & Marsha Thorne in R#1056754

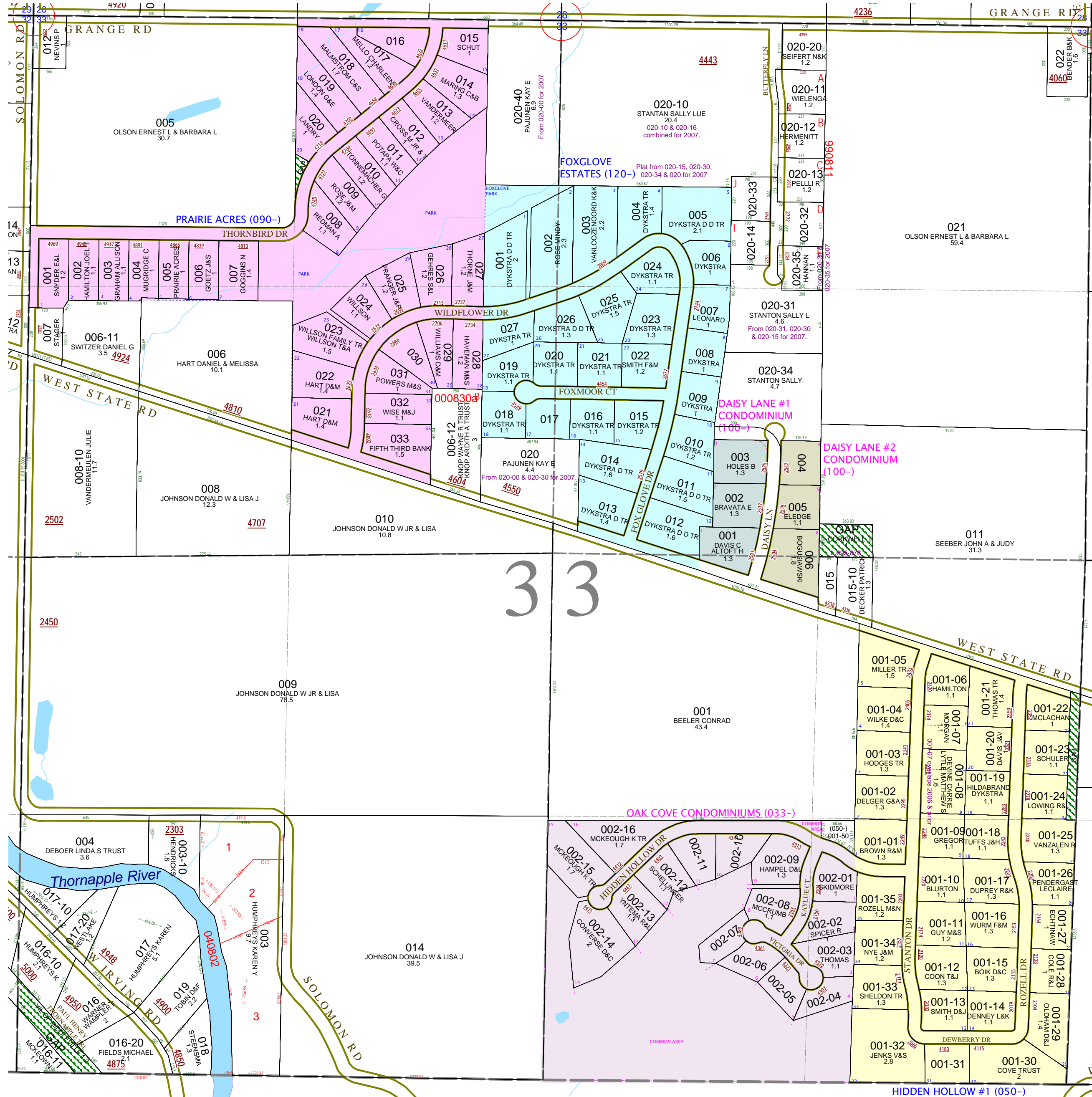

GAP owned by Corkwell in L.695-878 and not deeded onto Post in R#1068814.

GAP owned by the Village of Middleville subject to lease rights for the fiber-optic line to Michigan Central RR Co.

HIDDEN HOLLOW #1 (050-)