

Prairieville Township T 1 N R 10 W Barry County Michigan

Legend:

- Gap
- Overlap
- Address
- Real Property
- Personal Property
- Approved Split
- Plat
- Condominium
- Mobile Home Park

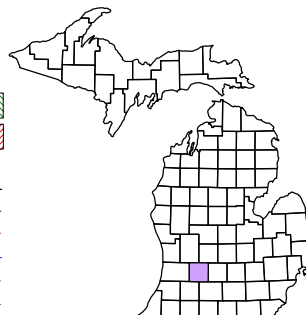

6	7	8	9	10	11
12	13	14	15	16	17
18	19	20	21	22	23
24	25	26	27	28	29
30	31	32	33	34	35
36					

Section 12 08-12-012- Scale 1"= 400'



This tax map was compiled for tax administration purposes from county and township records. It does not represent a land survey.
Barry County Land Information Services
220 West State Street, Hastings MI 49058
(269) 945-1292 or <http://www.barrycounty.org/>

November 1996
Revised May 1998
Revised September 2000
Revised August 2002
Revised November 2003
Revised January 2005
Revised April 2006
Revised May 2008

All dimensions are from tax roll unless noted below.
D = deeded M or S = surveyed
SR = Surveyor's Record prior to 1915
GLO = Government Land Office circa. 1830

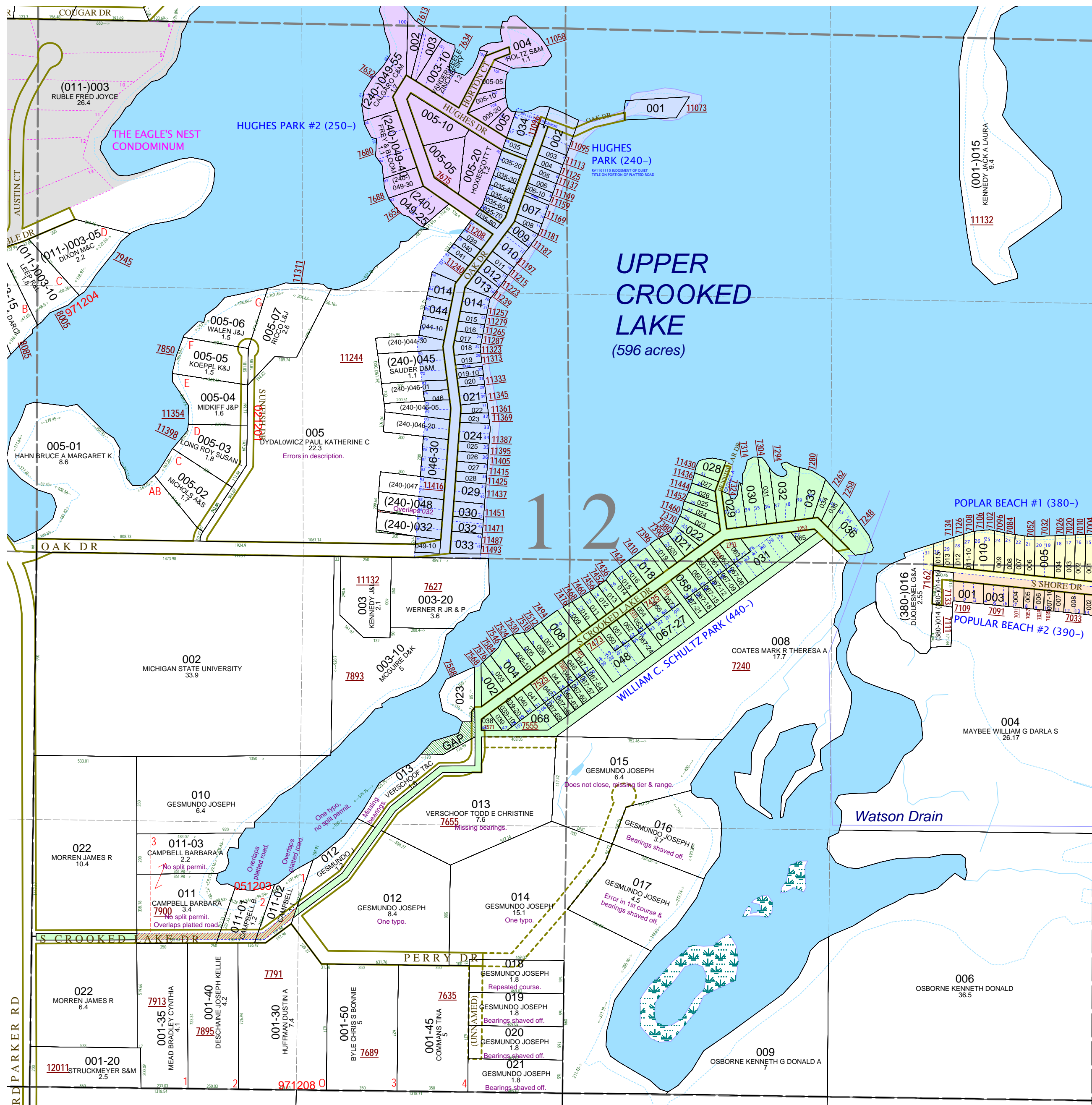

08-12-012-005-00 has a "zero" in the name field, does not close, has extra courses and is mixing measurements and bearings from two different surveys. They also messed up the lot extensions down by lots 87&88 creating a wedge overlap.

08-12-240-048-00 overlaps 032-00 because in change in how the lots were described between deeds. It should exclude parcel deeded previously to Phillips until a corrective survey description can be made.

GAP north of parcel 013-00 owned by Gesmundo.

08-12-012-013-00 is missing the seconds off the course bearings. Correction reads from deed L.590-727.

08-12-012-011-00 should not include platted road in William C. Shultz Park.

08-12-012-011-01 should not include platted road in William C. Shultz Park.

08-12-012-011-02 should not include platted road in William C. Shultz Park.

08-12-012-012-00 has one small typo, change "89D 45M 30S E, 1169.47 FT" to "N89°45'30"E 1169.47FT"

08-12-012-018-00 has a repeated course to its point of beginning.

08-12-012-019-00 has had its course bearings shaved off.

08-12-012-020-00 has had its course bearings shaved off.

08-12-012-021-00 has had its course bearings shaved off.

08-12-012-015-00 does not close, is missing tier & range and the seconds off the course bearings. We don't have a survey to totally reconstruct the missing parts

08-12-012-016-00 has had its bearings shaved off and should read as deeded in L.632-748.

08-12-012-017-00 has an error in first course and has had its bearings shaved off but I don't have the survey to totally reconstruct the missing parts.

08-12-012-014-00 has one small typo, change "TH 89D 45M 30S E, 1169.47 FT" to "TH N89°45'30"E 1169.47FT"