

Prairieville Township
T 1 N R 10 W
Barry County
Michigan

- Gap
- Overlap
- Address
- Real Property
- Personal Property
- Approved Split
- Plat
- Condominium
- Mobile Home Park

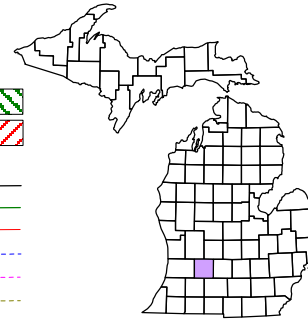

6	7	8	9	10	11	12	13
14	15	16	17	18	19	20	21
22	23	24	25	26	27	28	29
30	31	32	33	34	35	36	37

SE 1/4 Section 12
08-12-012-
Scale 1" = 200'

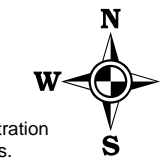

September 2000
Revised August 2002
Revised November 2003
Revised January 2005
Revised April 2006
Revised May 2008

All dimensions are from tax roll unless noted below.
D = deeded M or S = surveyed
SR = Surveyor's Record prior to 1915
GLO = Government Land Office circa. 1830

This tax map was compiled for tax administration purposes from county and township records. It does not represent a land survey.
Barry County Land Information Services
220 West State Street, Hastings MI 49058
(269) 945-1292 or <http://www.barrycounty.org/>

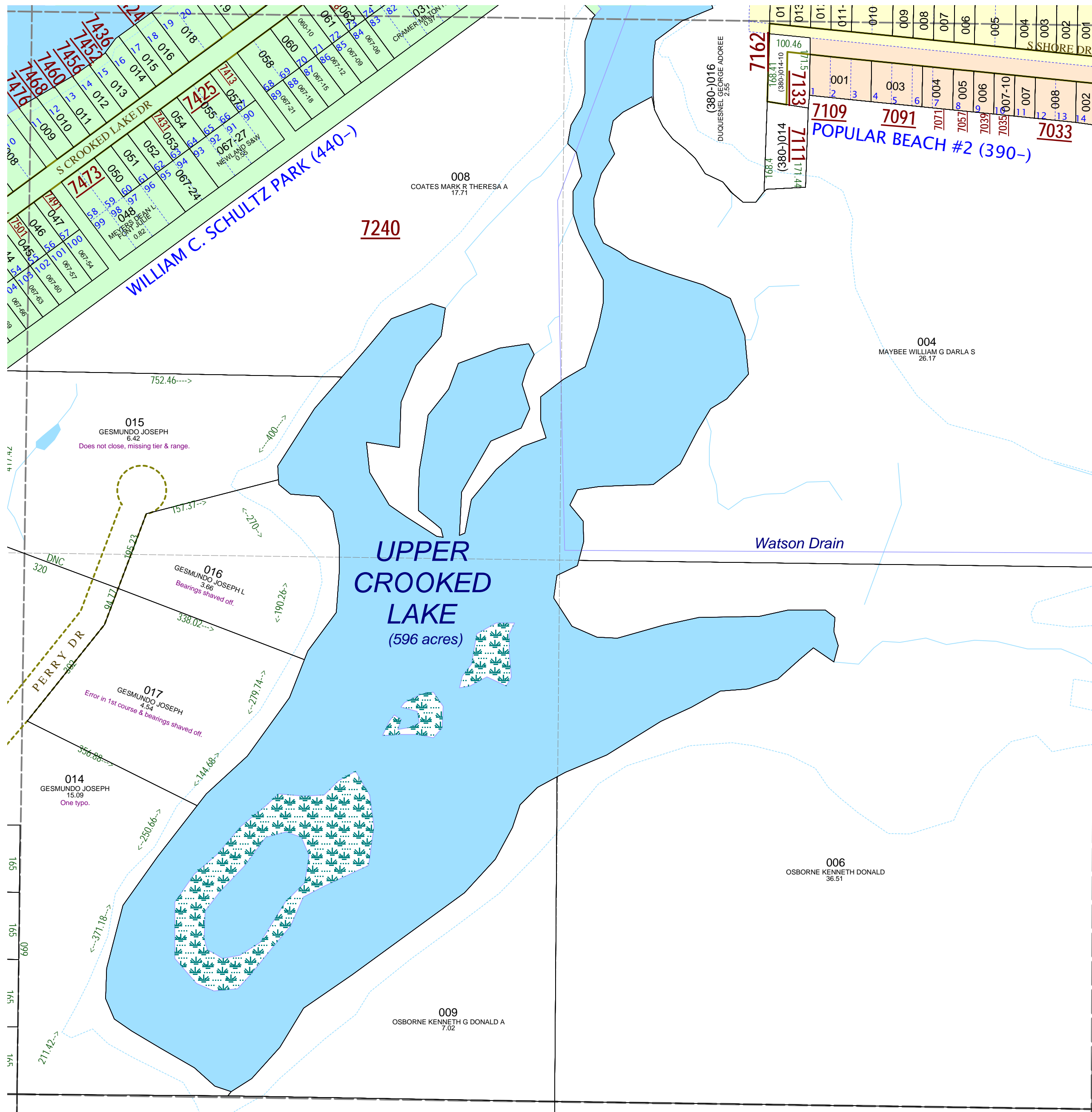

08-12-012-015-00 does not close, is missing tier & range and the seconds off the course bearings. We don't have a survey to totally reconstruct the missing parts

08-12-012-016-00 has had its bearings shaved off and should read as deeded in L.632-748.

08-12-012-017-00 has an error in first course and has had its bearings shaved off but I don't have the survey to totally reconstruct the missing parts.

08-12-012-014-00 has one small typo, change "TH 89D 45M 30S E, 1169.47 FT" to "TH N89°45'30"E 1169.47FT"

RCR