

Prairieville Township
T 1 N R 10 W
Barry County
Michigan

- Gap
- Overlap
- Address
- Real Property
- Personal Property
- Approved Split
- Plat
- Condominium
- Mobile Home Park

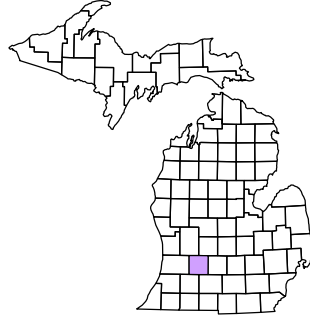

6	5	4	3	2	1
7	8	9	10	11	12
18	17	16	15	14	13
19	20	21	22	23	24
20	21	22	23	24	25
31	32	33	34	35	36

SE 1/4 Section 36
08-12-036-
Scale 1" = 200'

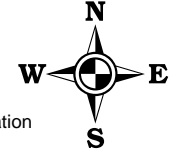

September 2000
Revised August 2002
Revised November 2003
Revised January 2005
Revised April 2006
Revised May 2008

All dimensions are from tax roll unless noted below.
D = deeded M or S = surveyed
SR = Surveyor's Record prior to 1915
GLO = Government Land Office circa. 1830

This tax map was compiled for tax administration purposes from county and township records. It does not represent a land survey.
Barry County Land Information Services
220 West State Street, Hastings MI 49058
(269) 945-1292 or <http://www.barrycounty.org/>

08-12-036-081-00 should include gap parcel to south as per R#1030162.

08-12-036-050-00 measure of 110.72 feet should be 110.22 feet.

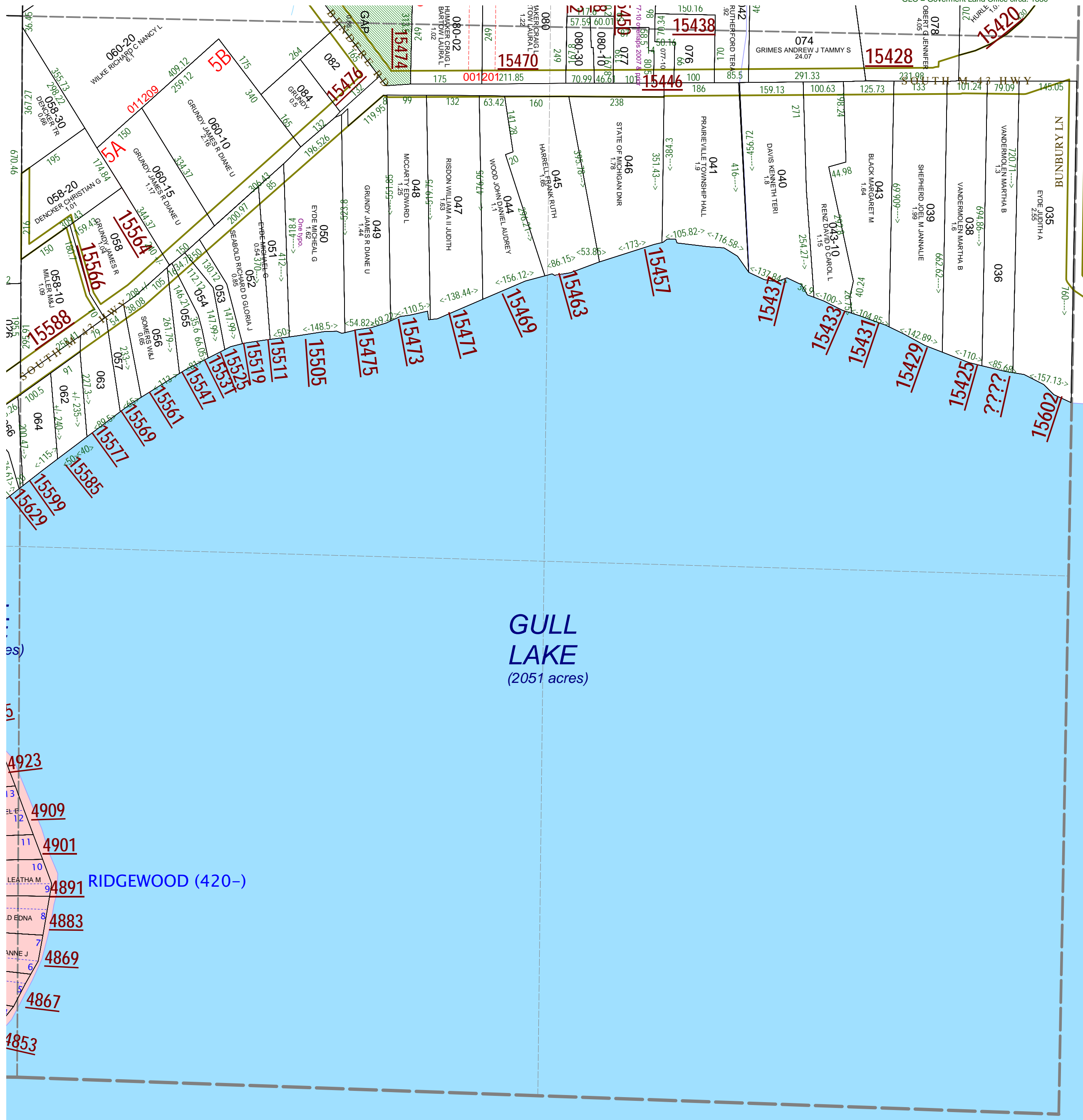

- 4923
- 4909
- 4901
- 4891 RIDGEWOOD (420-)
- 4883
- 4869
- 4867
- 4853