

Yankee Springs Township
T 3 N R 10 W
Barry County
Michigan

- Address 1234
- Gap
 - Overlap
 - Real Property
 - Personal Property
 - Approved Split
 - Plat
 - Condominium
 - Mobile Home Park

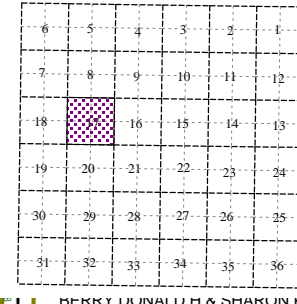

Section 17
08-16-017-
Scale 1" = 400'

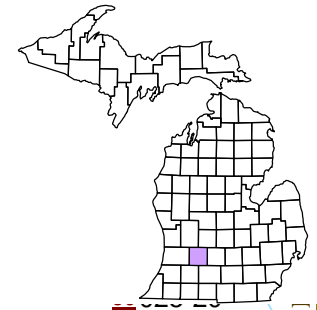

This tax map was compiled for tax administration purposes from county and township records. It does not represent a land survey.
 Barry County Land Information Services
 220 West State Street, Hastings MI 49058
 (269) 945-1292 or <http://www.barrycounty.org/>

October 1997
 Revised January 2000
 Revised July 2001
 Revised February 2003
 Revised April 2004
 Revised October 2005
 Revised April 2006
 Revised June 2008

All dimensions are from tax roll unless noted below.
 D = deeded, M or S = surveyed
 SR = Surveyor's Record prior to 1915
 GLO = Government Land Office circa. 1830

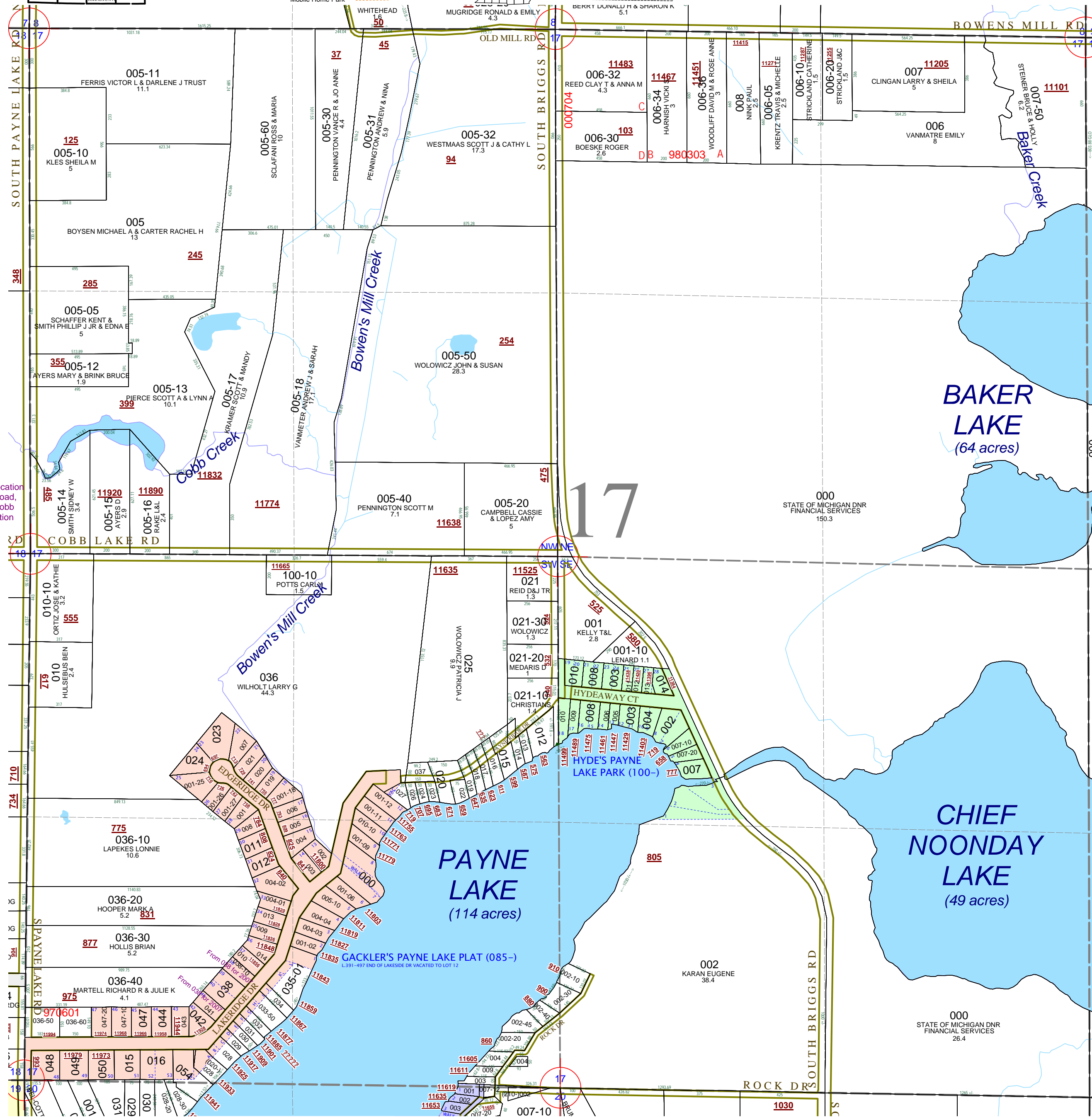

08-16-017-005-20 must be referring to the location of Briggs Rd prior to a straightening of said road, because the intersection of Briggs Rd and Cobb Lake Rd no longer occurs in the NW 1/4 section as referenced for point of beginning.

17