

Yankee Springs Township  
T 3 N R 10 W  
Barry County  
Michigan

Address 1234

- Gap
- Overlap
- Real Property
- Personal Property
- Approved Split
- Plat
- Condominium
- Mobile Home Park

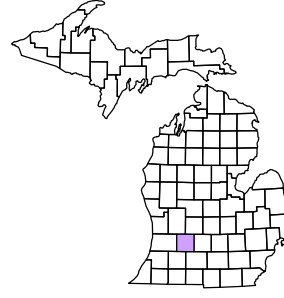

6	5	4	3	2	1	E
7	8	9	10	11	12	
18	17	16	15	14	13	
19	20	21	22	23	24	
29	28	27	26	25		
31	32	33	34	35	36	

NE 1/4 Section 33  
08-16-033-  
Scale 1"= 200'

This tax map was compiled for tax administration purposes from county and township records. It does not represent a land survey. Barry County Land Information Services 220 West State Street, Hastings MI 49058 (269) 945-1292 or <http://www.barrycounty.org/>



January 2000  
Revised July 2001  
Revised February 2003  
Revised April 2004  
Revised October 2004  
Revised April 2006  
Revised June 2008

All dimensions are from tax roll unless noted below.  
D = deeded M or S = surveyed  
SR = Surveyor's Record prior to 1915  
GLO = Government Land Office circa. 1830

08-16-190-019-00 needs to include a 10 foot wide parcel on its north side which was not conveyed in R#1132148.

08-16-033-005-20 overlaps 190-023-00, one is surveyed and the other is at "point east of northeast corner lot 79"

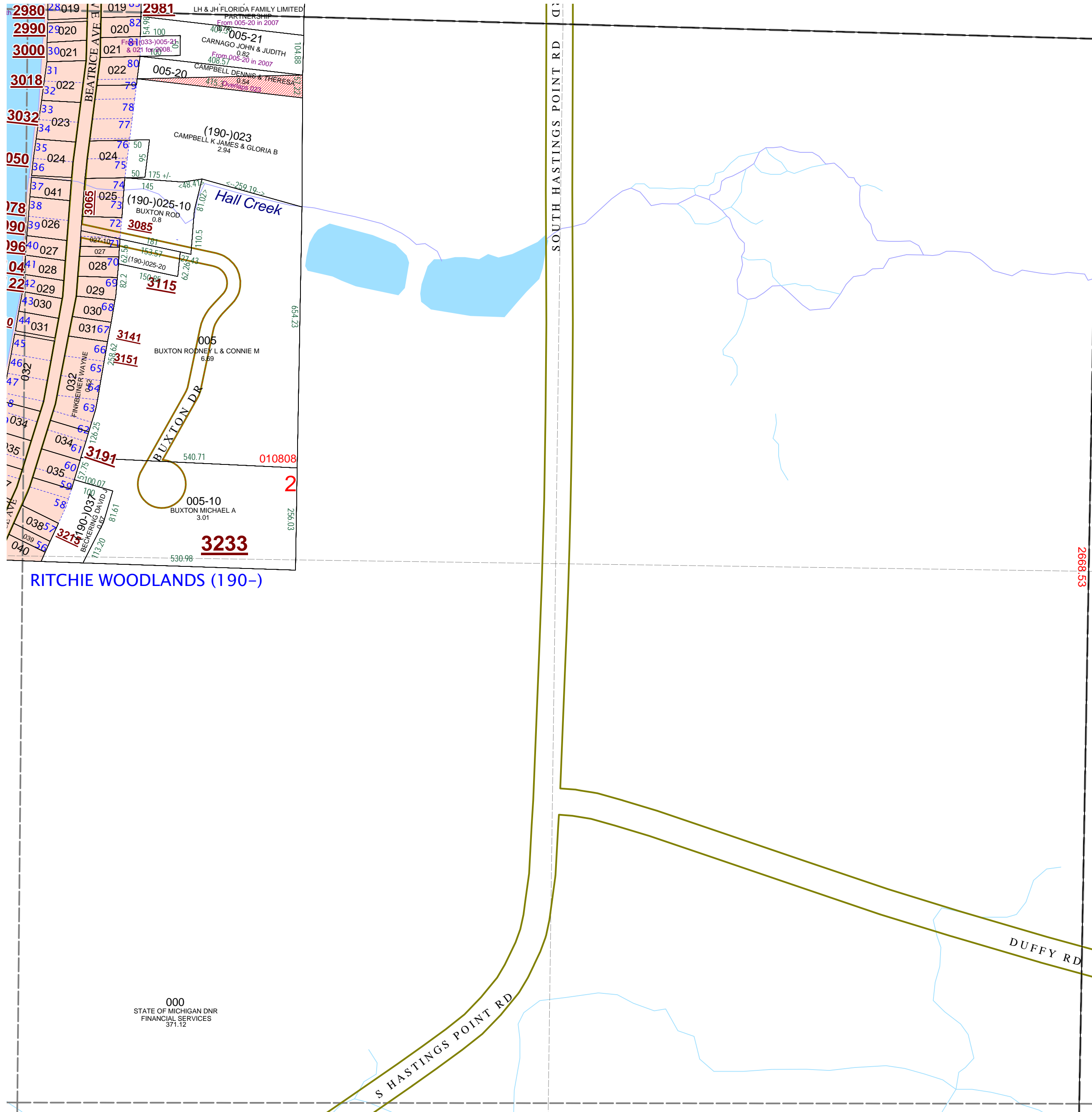

000  
STATE OF MICHIGAN DNR  
FINANCIAL SERVICES  
371.12