

Barry Township
T 1 N R 9 W
Barry County
Michigan

- Gap Overlap
- Address
- Real Property
- Personal Property
- Approved Split
- 1999 Waterlevel
- Plat
- Condominium

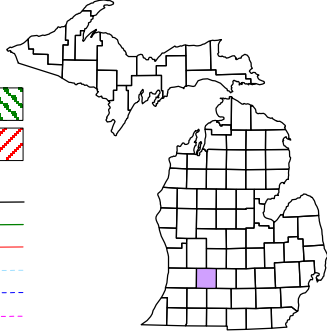

| | | | | | | |
|----|----|----|----|----|----|----|
| 6 | 7 | 8 | 9 | 10 | 11 | 12 |
| 13 | 14 | 15 | 16 | 17 | 18 | 19 |
| 20 | 21 | 22 | 23 | 24 | 25 | 26 |
| 27 | 28 | 29 | 30 | 31 | 32 | 33 |
| 34 | 35 | 36 | 37 | 38 | 39 | 40 |

NW 1/4 Section 5
08-03-005-
Scale 1" = 200'



July 1999
Revised May 2000
Revised April 2002
Revised October 2003
Revised July 2005
Revised October 2006
Revised October 2008

This tax map was compiled for tax administration purposes from county and township records. It does not represent a land survey. Barry County Land Information Services 220 West State Street, Hastings MI 49058 (269) 945-1292 or http://www.barrycounty.org/

All dimensions are from tax roll unless noted below.
D = deeded M or S = surveyed
SR = Surveyor's Record prior to 1915
GLO = Government Land Office circa. 1830

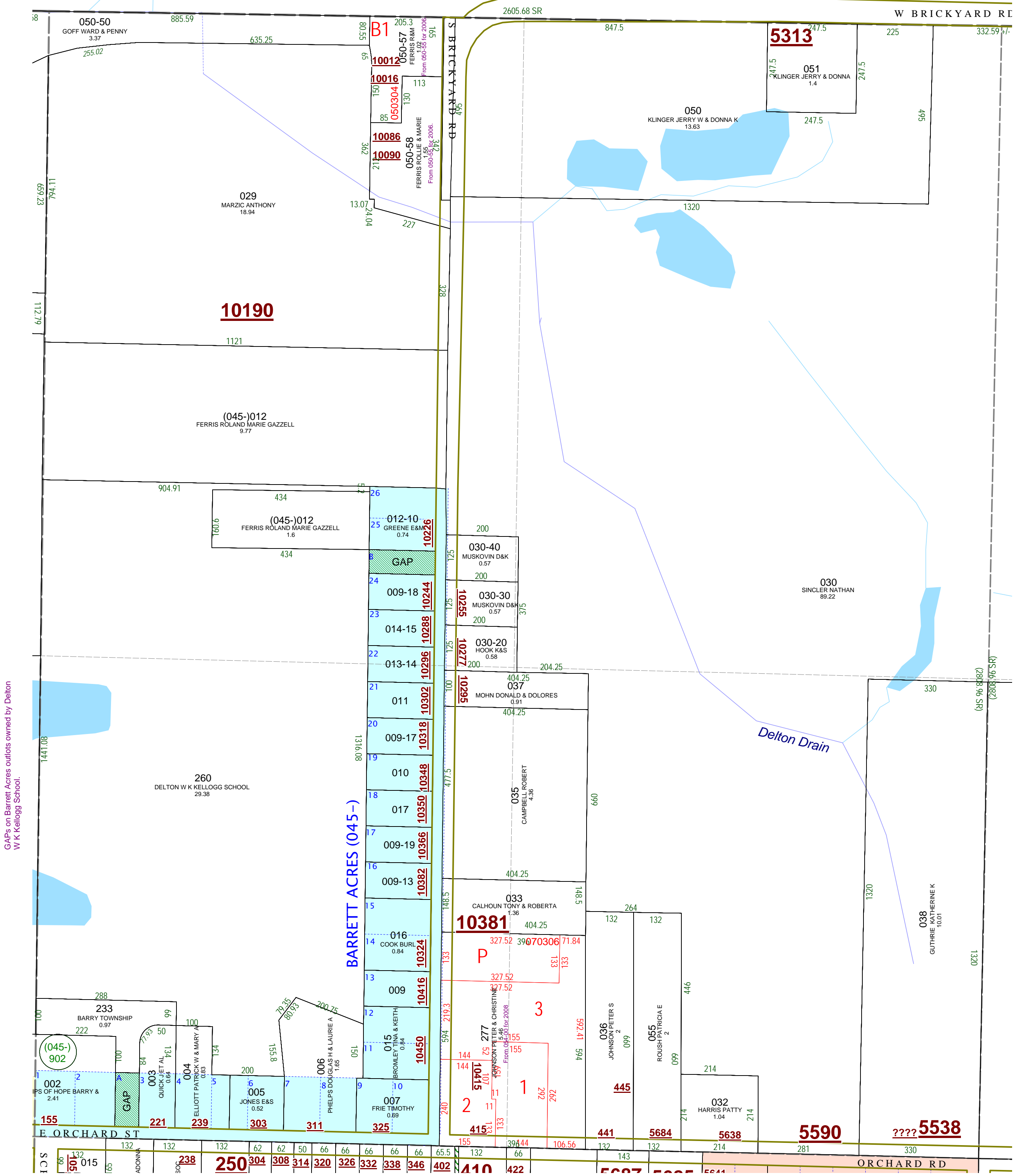

GAPs on Barrett Acres outlots owned by Delton W K Kellogg School.