

Barry Township
T 1 N R 9 W
Barry County
Michigan

- Gap Overlap
- Address
- Real Property
- Personal Property
- Approved Split
- 1999 Waterlevel
- Plat
- Condominium

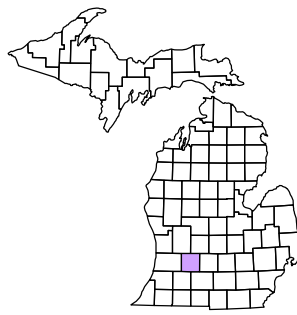

6	5	4	3	2	1																														
7	6	5	4	3	2	1																													
8	7	6	5	4	3	2	1																												
9	8	7	6	5	4	3	2	1																											
10	9	8	7	6	5	4	3	2	1																										
11	10	9	8	7	6	5	4	3	2	1																									
12	11	10	9	8	7	6	5	4	3	2	1																								
13	12	11	10	9	8	7	6	5	4	3	2	1																							
14	13	12	11	10	9	8	7	6	5	4	3	2	1																						
15	14	13	12	11	10	9	8	7	6	5	4	3	2	1																					
16	15	14	13	12	11	10	9	8	7	6	5	4	3	2	1																				
17	16	15	14	13	12	11	10	9	8	7	6	5	4	3	2	1																			
18	17	16	15	14	13	12	11	10	9	8	7	6	5	4	3	2	1																		
19	18	17	16	15	14	13	12	11	10	9	8	7	6	5	4	3	2	1																	
20	19	18	17	16	15	14	13	12	11	10	9	8	7	6	5	4	3	2	1																
21	20	19	18	17	16	15	14	13	12	11	10	9	8	7	6	5	4	3	2	1															
22	21	20	19	18	17	16	15	14	13	12	11	10	9	8	7	6	5	4	3	2	1														
23	22	21	20	19	18	17	16	15	14	13	12	11	10	9	8	7	6	5	4	3	2	1													
24	23	22	21	20	19	18	17	16	15	14	13	12	11	10	9	8	7	6	5	4	3	2	1												
25	24	23	22	21	20	19	18	17	16	15	14	13	12	11	10	9	8	7	6	5	4	3	2	1											
26	25	24	23	22	21	20	19	18	17	16	15	14	13	12	11	10	9	8	7	6	5	4	3	2	1										
27	26	25	24	23	22	21	20	19	18	17	16	15	14	13	12	11	10	9	8	7	6	5	4	3	2	1									
28	27	26	25	24	23	22	21	20	19	18	17	16	15	14	13	12	11	10	9	8	7	6	5	4	3	2	1								
29	28	27	26	25	24	23	22	21	20	19	18	17	16	15	14	13	12	11	10	9	8	7	6	5	4	3	2	1							
30	29	28	27	26	25	24	23	22	21	20	19	18	17	16	15	14	13	12	11	10	9	8	7	6	5	4	3	2	1						
31	30	29	28	27	26	25	24	23	22	21	20	19	18	17	16	15	14	13	12	11	10	9	8	7	6	5	4	3	2	1					
32	31	30	29	28	27	26	25	24	23	22	21	20	19	18	17	16	15	14	13	12	11	10	9	8	7	6	5	4	3	2	1				
33	32	31	30	29	28	27	26	25	24	23	22	21	20	19	18	17	16	15	14	13	12	11	10	9	8	7	6	5	4	3	2	1			
34	33	32	31	30	29	28	27	26	25	24	23	22	21	20	19	18	17	16	15	14	13	12	11	10	9	8	7	6	5	4	3	2	1		
35	34	33	32	31	30	29	28	27	26	25	24	23	22	21	20	19	18	17	16	15	14	13	12	11	10	9	8	7	6	5	4	3	2	1	
36	35	34	33	32	31	30	29	28	27	26	25	24	23	22	21	20	19	18	17	16	15	14	13	12	11	10	9	8	7	6	5	4	3	2	1

NW 1/4 Section 7
08-03-007-
Scale 1"= 200'



July 1999
Revised May 2000
Revised April 2002
Revised October 2003
Revised July 2005
Revised October 2006
Revised October 2008

This tax map was compiled for tax administration purposes from county and township records. It does not represent a land survey. Barry County Land Information Services 220 West State Street, Hastings MI 49058 (269) 945-1292 or http://www.barrycounty.org/

All dimensions are from tax roll unless noted below. D = deeded M or S = surveyed SR = Surveyor's Record prior to 1915 GLO = Government Land Office circa. 1830

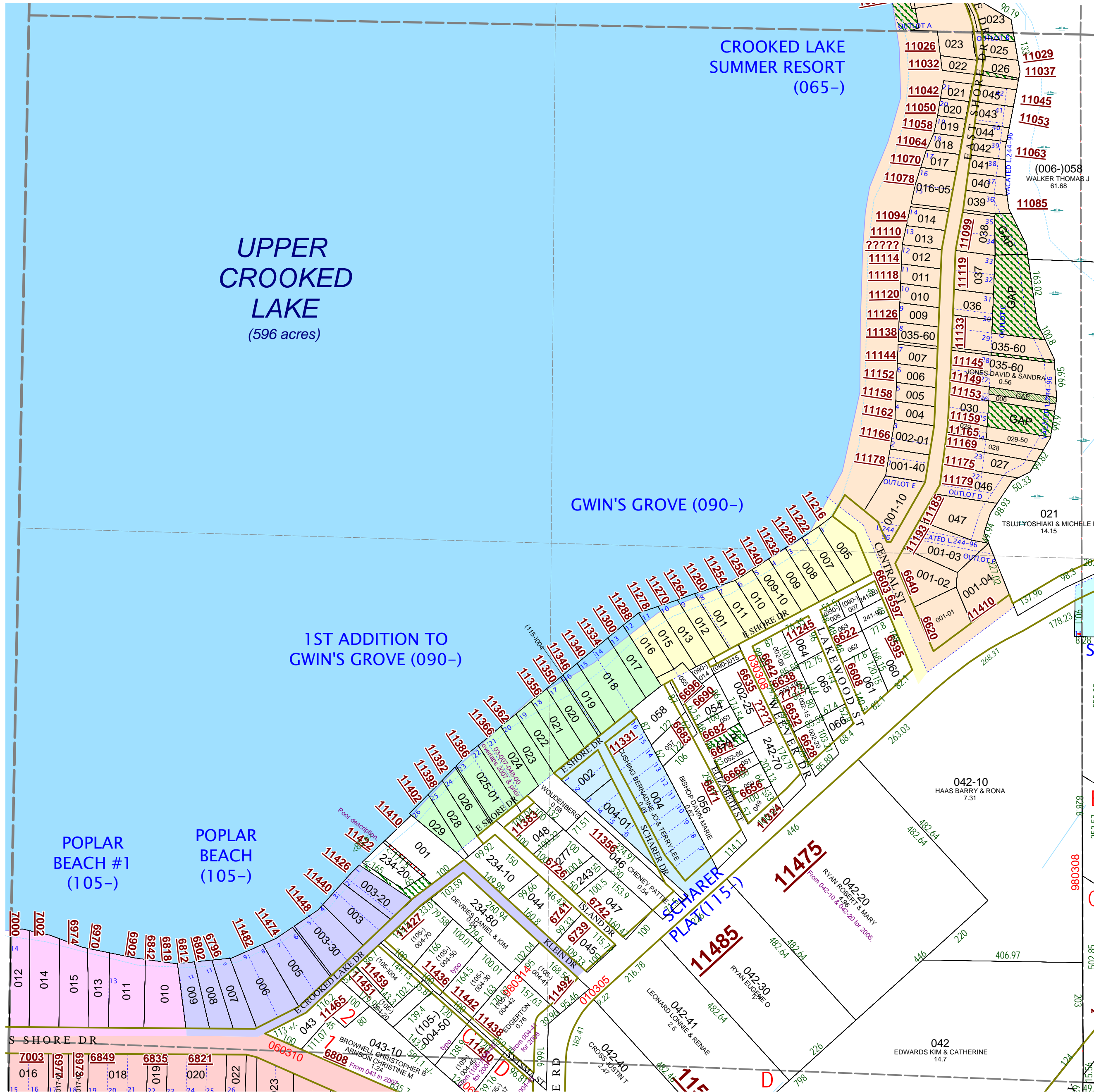

08-03-065-023-00 needs to include lake front parcel (not on R#1008351).

GAP in outlet B owned by the Estate of Mary Baker, Raymond H. Baker heir designate in L.152-121.

GAP in outlet C owned by Cornelius J. VerCies in L.188-557.

GAP in outlet C owned by Melvin Raab in L.640-877.

08-03-065-006-00 needs to include gap to the east because it didn't get it all the parcels from the combination made in 2005.

08-06-065-030-00 needs to include gap parcel to its east. See R#1165062.

08-03-007-052-60 needs to include gap parcel to the northwest.

08-03-007-234-20 has a poor point of beginning. I think they assumed the south corner of Gwin's Grove was on the southerly point of the old road way rather than on the south corner of the lot.

08-03-105-007-00 has the plat name misspelled, it should be "POPLAR" not Popular.
08-03-105-008-00 has the plat name misspelled, it should be "POPLAR" not Popular.
08-03-105-004-50 has a small typo, change "TH 49D 1M 29S E 79.58 FT" to "TH S49°01'29"E 79.58FT".