

Village of Nashville
T 3 N R 7 W
Barry County
Michigan
Sheet 5

- Address 1234
- Gap
- Overlap
- Real Property
- Personal Property
- Approved Split
- Plat
- Condominium
- Mobile Home Park

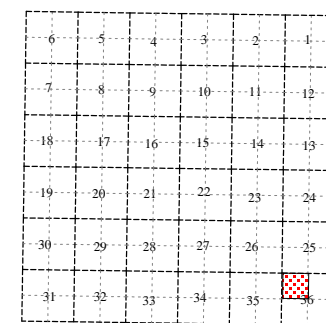
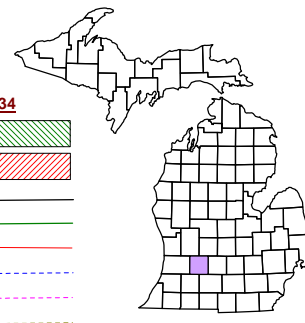

NW 1/4 Section 36
08-52-002-
Scale 1" = 200'

This tax map was compiled for tax administration purposes from county and township records. It does not represent a land survey. Barry County Land Information Services 220 West State Street, Hastings MI 49058 (269) 945-1292 or <http://www.barrycounty.org/>



October 1997
Revised October 1999
Revised February 2001
Revised January 2003
Revised June 2004
Revised May 2005
Revised February 2007
Revised January 2009

All dimensions are from tax roll unless noted below.
D = deeded M or S = surveyed
SR = Surveyor's Record prior to 1915
GLO = Government Land Office circa. 1830

GAP which is the easterly extension of Brumm River Dr (Brumm St) overlapped by garage at 820 N Main St owned by Mary J. Kellogg in L.74-76 and not partitioned out.

GAP properties south of the dam with electric lines for Village of Nashville.

08-52-000-110-00 overlaps 111-00 by one-half foot and should read as deeded in R#1115336.

GAP which is the parking lot owned by Village of Nashville.

GAP in lot 9 Assessor's Plat #1 in the Village of Nashville last deeded to Menton Z. & Nyla Jean Watras in L.342-199 on April 22, 1971.

GAP-00 which is in lot 52 of Nashville Village. It is owned by S.J. & Maria I. Wheeler in L.41-507 and not sold off in L.187-361 or L.193-59.

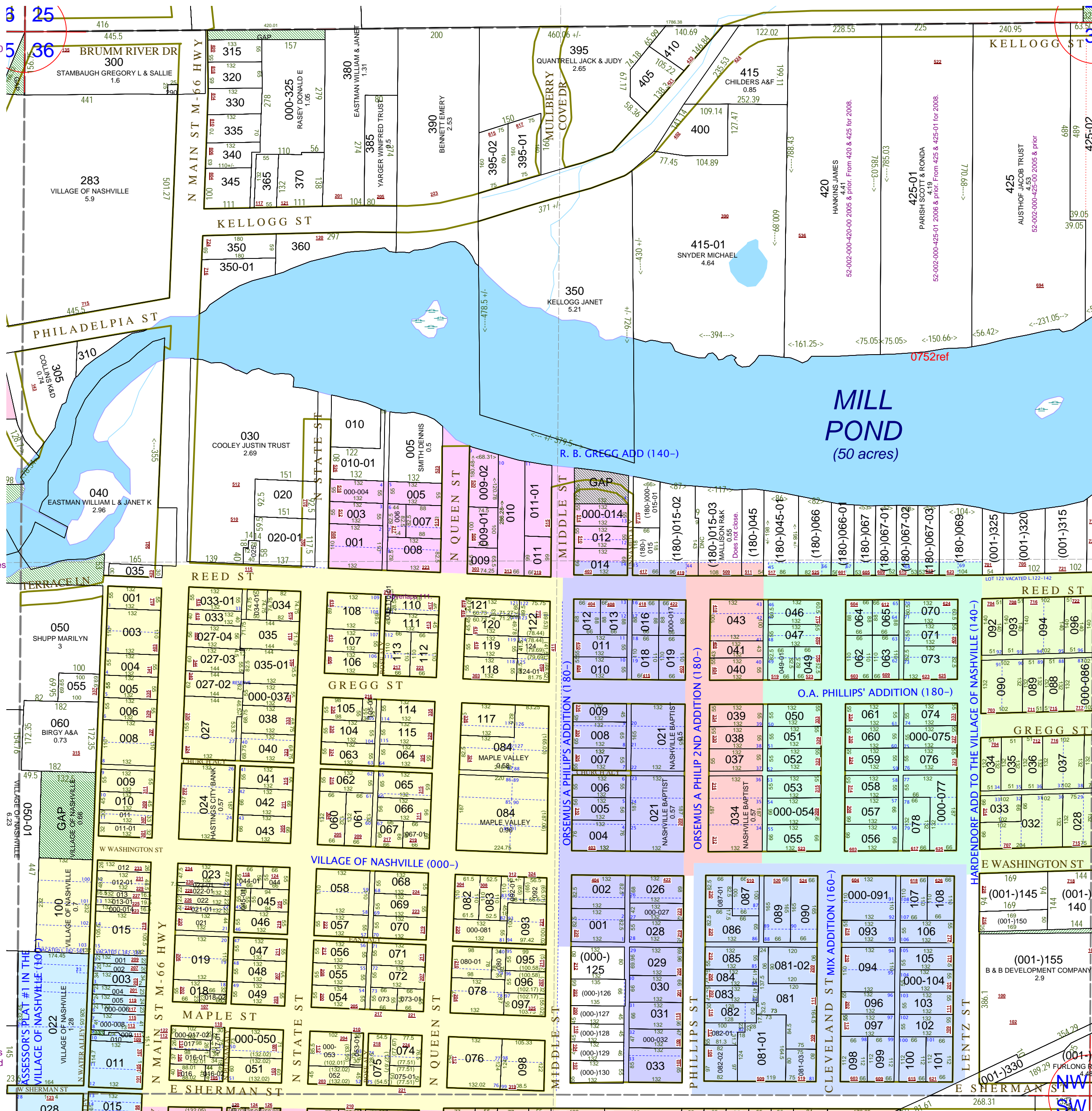

GAP in lot 14 of R.B. Gregg Addition owned by the Village of Nashville in L.157-426.

08-52-180-015-03 does not close because it is missing its last course.

GAP which is extension of alley from Hardendorff Add to Lentz St

