

Village of Middleville
T 4 N R 10 W
Barry County
Michigan
Sheet 10

- Address 12345
- Gap
- Overlap
- Real Property
- Personal Property
- Approved Split
- Plat
- Condominium
- Mobile Home Park

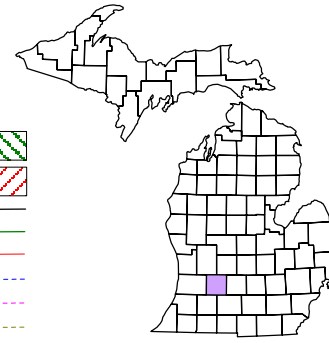

6	5	4	3	2	1
7	8	9	10	11	12
18	17	16	15	14	13
19	20	21	22	23	24
30	29	28	27	26	25
31	32	33	34	35	36

NE 1/4 Section 27
08-41-027-
Scale 1" = 200'

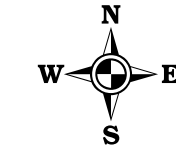

August 1997
Revised April 1999
Revised June 2000
Revised July 2002
Revised May 2003
Revised August 2004
Revised August 2005
Revised December 2006
Revised November 2007
Revised July 2009

All dimensions are from tax roll unless noted below:
Dimensions in parentheses are calculated:
D = deeded versus M or S = surveyed
SR = Surveyor's Record prior to 1915
GLO = Government Land Office circa. 1830
LCRC = Land Corner Recordation Certificate

This tax map was compiled for tax administration purposes from county and township records. It does not represent a land survey.
Barry County Land Information Services
220 West State Street, Hastings MI 49058
(269) 945-1292 or <http://www.barrycounty.org/>

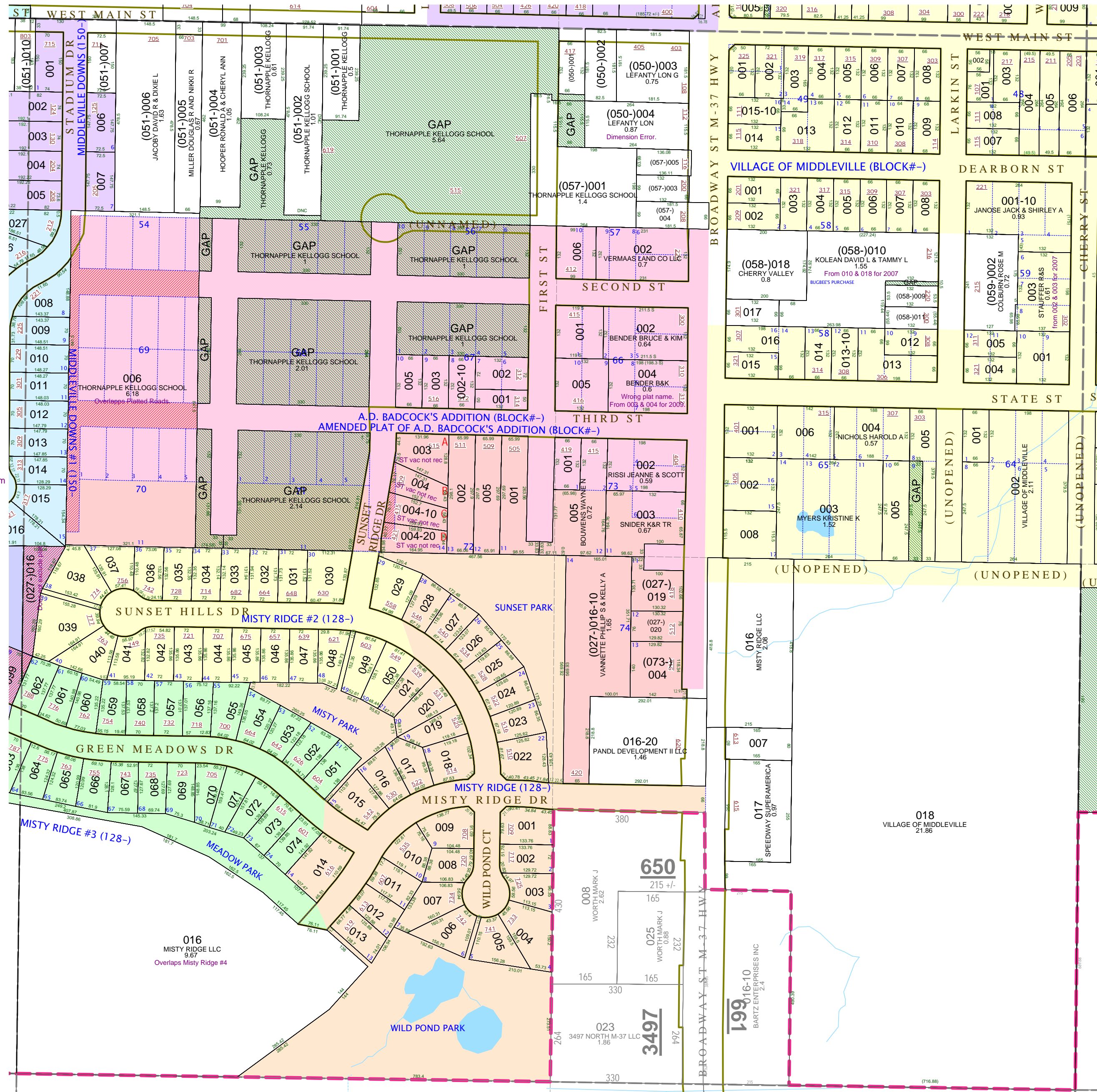

41-051-002-00 is missing two courses.

GAPs owned by Thornapple Kellogg Schools in various deeds.

08-41-145-006-00 claims platted roads

08-41-072-003-00, 004-00, 004-10 & 004-20 claim street which has not been vacated according to recorded deeds and vacations with the county.

08-41-027-016-00 needs to exclude Misty Ridge #4 too.

08-41-050-001-00 also should have another 12 feet added to its east as deeded.

08-41-050-002-00 should exclude the west 12 feet which should be with 001.

08-41-050-004-00 has two typos and should include gap to its west.

GAP owned by Albert F. & Emma A. Finkbeiner in WD L.233-129 from Mary Finkbeiner on May 22nd 1958 (not sold onto Inez Laughbaugh).

08-41-066-004-00 has wrong plat name.

GAP in block 65 owned by William Severence in L.59-39 (1888)

016
MISTY RIDGE LLC
9.67
Overlaps Misty Ridge #4

018
VILLAGE OF MIDDLEVILLE
21.86

650
WORTHMARK J
2.62

3497
3497 NORTH M-37 LLC
1.86

199
BARTZEN ENTERPRISES INC
2.4