

Thornapple Township
T 4 N R 10 W
Barry County
Michigan

- Address 12345
- Gap
- Overlap
- Real Property
- Personal Property
- Approved Split
- Plat
- Condominium
- Mobile Home Park

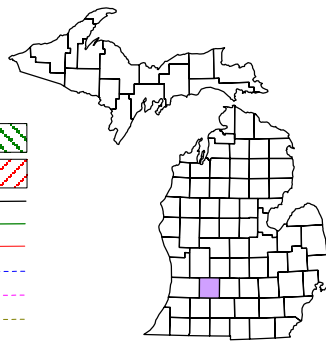

| | | | | | |
|----|----|----|----|----|----|
| 6 | 5 | 4 | 3 | 2 | 1 |
| 7 | 8 | 9 | 10 | 11 | 12 |
| 13 | 14 | 15 | 16 | 17 | 18 |
| 19 | 20 | 21 | 22 | 23 | 24 |
| 25 | 26 | 27 | 28 | 29 | 30 |
| 31 | 32 | 33 | 34 | 35 | 36 |

Section 15
08-14-015-
Scale 1" = 400'

This tax map was compiled for tax administration purposes from county and township records. It does not represent a land survey.
Barry County Land Information Services
220 West State Street, Hastings MI 49058
(269) 945-1292 or <http://www.barrycounty.org/>

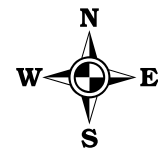

- May 1996
- Revised August 1997
- Revised April 1999
- Revised June 2000
- Revised July 2002
- Revised May 2003
- Revised July 2004
- Revised August 2005
- Revised December 2006
- Revised December 2007
- Revised July 2009

All dimensions are from tax roll unless noted below:
Dimensions in parentheses are calculated
D = deeded versus M or S = surveyed
SR = Surveyor's Record prior to 1915
GLO = Government Land Office circa. 1830
LCRC = Land Corner Recordation Certificate

08-14-015-015-30 does not match property deeded in L.599-593 and needs to exclude property in NW 1/4 NW 1/4.

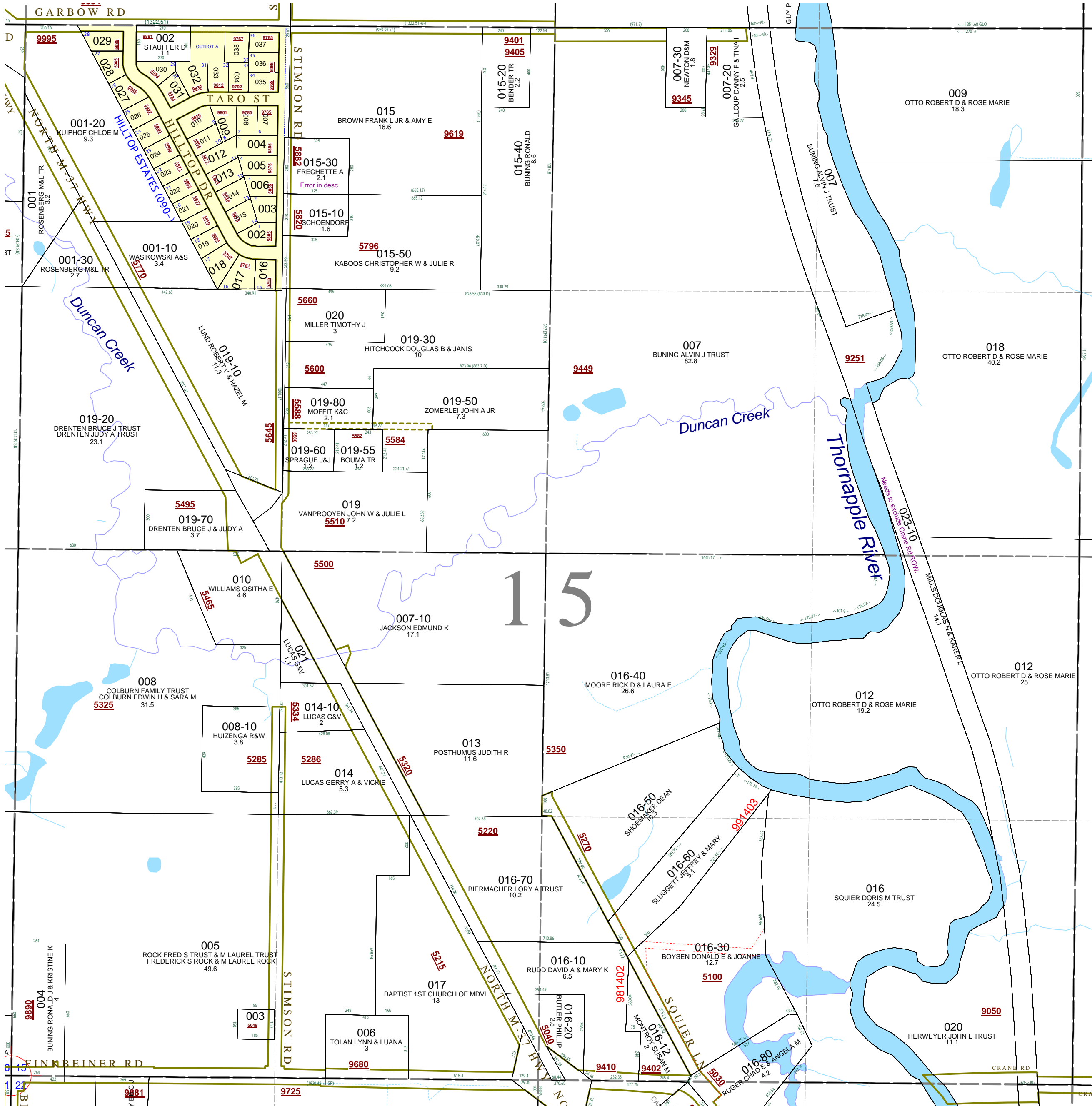

08-14-015-023-10 needs to exclude parcel deeded to Barry County Road Commission in #200906160006319.